



NEDERLANDSE **TRANSPLANTATIE** VERENIGING



# Joint NTV-BTS Transplantation Congress 2018

Scientific Spring Meeting  
Nederlandse Transplantatie Vereniging  
Belgian Transplantation Society

**March 15<sup>th</sup>-16<sup>th</sup>, 2018**  
**De Doelen, Rotterdam**

organised in collaboration with



# Content

<b>Information</b>	<b>4</b>
<i>Organizing committee 2018</i>	4
<i>Accreditation</i>	5
<i>Information De Doelen and WiFi-network</i>	6
<i>Floorplan De Doelen</i>	7
<i>Presentation and poster information</i>	10
<i>Time and location of meals</i>	10
<i>Assemblies NTV and BTS</i>	11
<b>Program schedule Thursday morning</b>	<b>12</b>
<i>Plenary session 1: Borders Crossed</i>	16
<i>Parallel session 2: Basic / translational research</i>	17
<i>Parallel session 3: Clinical</i>	19
<i>Parallel session 4: Nursing</i>	22
<i>Parallel session 5: Clinical</i>	23
<i>Teaching session (during lunch)</i>	25
<b>Program schedule Thursday afternoon</b>	<b>13</b>
<i>Plenary session 6: New and different borders</i>	26
<i>Poster session 1: Nursing</i>	27
<i>Poster session 2: Clinical</i>	28
<i>Poster session 3: Clinical</i>	30
<i>Poster session 4: Basic translational research</i>	32
<i>Poster session 5: Donation</i>	33
<i>Parallel session 7: Basic / translational research</i>	35
<i>Parallel session 8: Clinical</i>	37
<i>Parallel session 9: Nursing</i>	38
<i>Parallel session 10: Donation</i>	40
<i>General assemblies NTV and BTS</i>	42

**Program schedule Friday morning** **14**

*Plenary session 11: Crossing borders in basic & translational science* 43

*Poster session 6: Clinical* 43

*Poster session 7: Clinical* 45

*Poster session 8: Basic translational research* 46

*Poster session 9: Donation* 48

*Parallel session 12: Basic / translational research* 49

**Program schedule Friday afternoon** **15**

*Parallel session 13: Clinical* 50

*Parallel session 14: Transplant coordination – casus session* 53

*Parallel session 15: Clinical* 54

*Plenary session 16: Same borders for doctors and patients?* 56

*Parallel session 17: Young professionals in Transplantation* 57

*Parallel session 18: Clinical* 58

*Parallel session 19: Nierteam aan huis* 60

*Award session* 60

*Closing* 60

**Information NTV** **61**

# Organising Committee 2018

## *Erasmus MC*

Carla Baan  
Herold Metselaar  
Martin Hoogduijn  
Marian Clahsen-van Groningen  
Karlien Cransberg  
Teun van Gelder  
Hanneke Hagenaars  
Rogier Hoek  
Jeroen de Jonge  
Luc van der Laan  
Louise Maasdam  
Jacqueline van de Wetering  
Olivier Manintveld

## *Bestuursleden BTS*

Olivier Detry  
Geert Roeyen  
Olivier Van Caenegem  
Nicolas Meurisse

## *Bestuursleden Nederlandse Transplantatie Vereniging*

Marlies Reinders  
Martin Hoogduijn  
Jeroen de Jonge  
Henri Leuvenink  
Henny Otten  
Coby Annema-de Jong  
Ed van de Graaff

## *Vanuit het secretariaat NTV te Haarlem*

Tineke Flietstra  
Marie José van Gijtenbeek  
Melanie IJzelenberg

## **Participerende patiëntenverenigingen**

Harten Twee  
Nederlandse Leverpatiënten Vereniging  
Nierpatiënten Vereniging Nederland  
Nederlandse Cystic Fibrosis Stichting

Nederlandse  
Leverpatiënten  
Vereniging



## **Accreditation - NTV**

*Wordt aangevraagd bij de volgende verenigingen:*

Nederlandse Vereniging voor Cardiologie

Nederlandse Vereniging voor Heelkunde

Nederlandse Vereniging voor Immunologie

Nederlandse Internisten Vereniging

Nederlandse Vereniging voor Kindergeneeskunde

Nederlandse Vereniging van Artsen voor Longziekten en Tuberculose

Nederlandse Vereniging van Maag-Darm-Leverartsen

Nederlandse Vereniging voor Thoraxchirurgie

V&VN, kwaliteitsregister algemeen

V&VN, kwaliteitsregister, deskundigheidsgebied Dialyse

V&VN, verpleegkundig specialisten register

## **CME points - BTS**

to be announced

## De Doelen, Rotterdam

Kruisplein 40

entrance: Willem Burgerzaal

3012 CL Rotterdam

Tel: (+31) 010 – 2171717

Website:

<http://www.dedoeleniccrotterdam.nl/>



### Public transport

De Doelen is located at 1 min walking distance from Rotterdam Central Station. Busses, trains, metros and trams all stop at the Central Station.

### Walking route from Central Station

Here you find the walking route from the Central Station to de Doelen, entrance Willem Burger Complex.

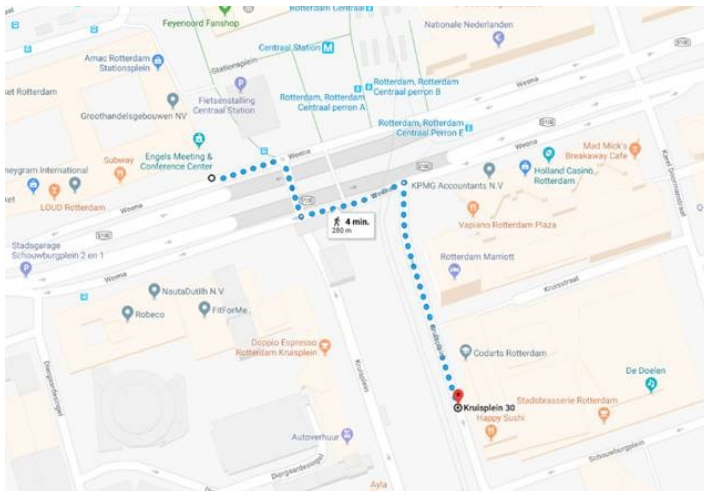

### Parking

There are several secure car parks in the direct vicinity of the venue. For Parking De Doelen sells tickets with a reduced price for the parking garage at Schouwburgplein 1 and 2. Parking Kruisplein/Schouwburgplein (follow sign P Centraal Station).  
6-hrs à € 8,50; 8-hrs à € 12,50; 12-hrs à € 15,00 incl. VAT

### Free WiFi De Doelen (foyers)

De Doelen

pass word: 30123012

# Floor plan De Doelen

## Ground floor

Entrance Kruisplein 40  
Willem Burger Hal  
Registration desk

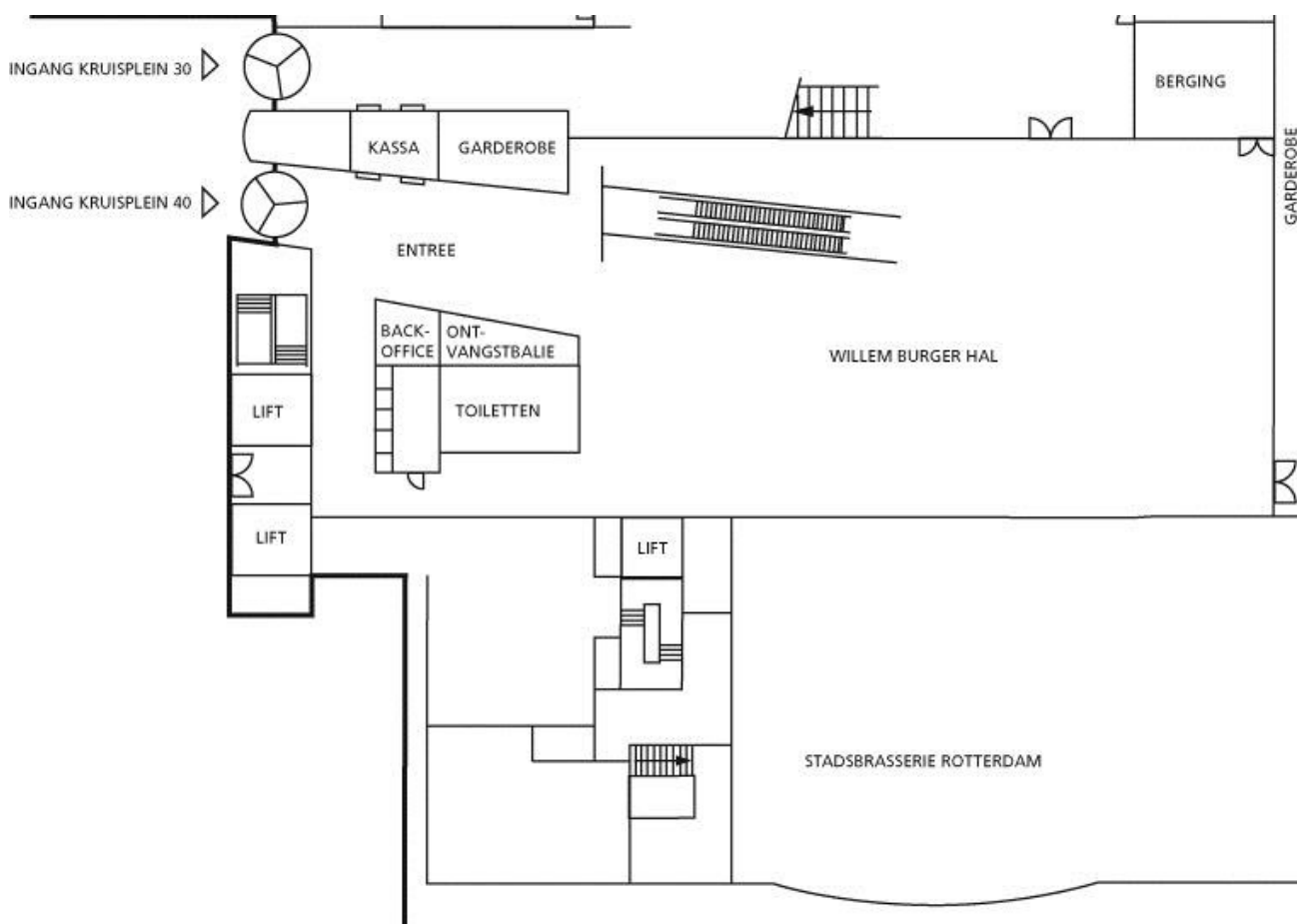

# Floor plan De Doelen

## Third floor

Hudig Zaal

Willem Burger Zaal

Willem Burger Foyer

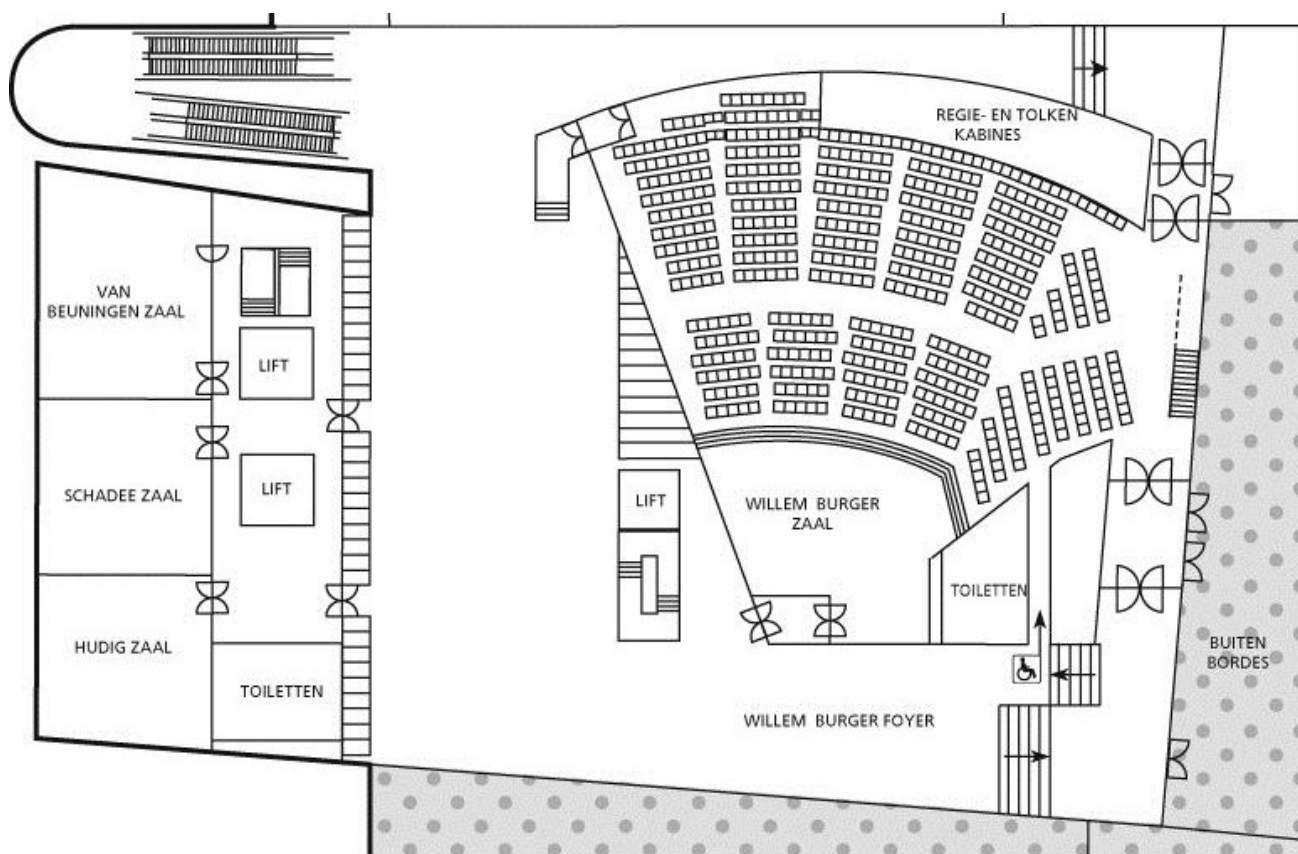



# Floor plan De Doelen

## Fourth floor

Van Rijckevorsel Zaal / Ruys Zaal

Van der Vorm Zaal / Plate Zaal

Van Weelde Zaal

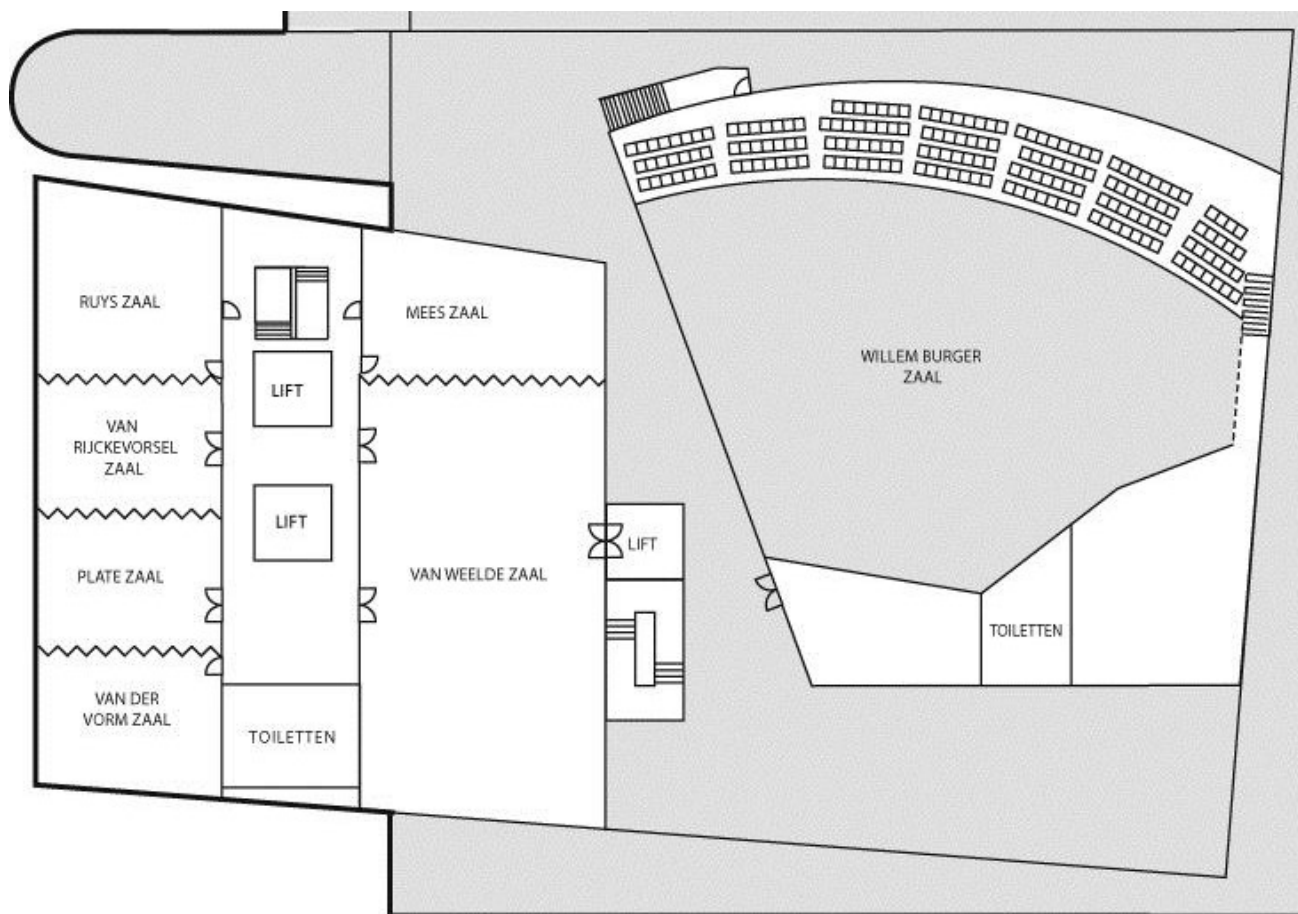

## **Presentations**

Presenters of ORAL presentations are requested to hand in their slides in time at the day of their presentation in the Hudig Zaal on the third floor (accessible by elevator from the Willem Burger Hal).

## **Poster session**

The posters are grouped by subject. Posters should be mounted on the poster boards with the corresponding numbers on Thursday no later than 11.30h and removed at the end of the meeting (Friday afternoon). Apart from the official poster session on Thursday and Friday, we envision informal discussions around posters during coffee and tea-breaks in between the oral sessions.

## **Time and locations of lunches and dinner**

### **Thursday**

*Lunch:* 13.00 – 14.00 hrs Willem Burger Foyer  
(there are lunch boxes for participants of the education session at the entrance of the Van Weelde Zaal)

### *Dinner and transfer*

Transfer from De Doelen to ss Rotterdam: 19.00h)

Diner ss Rotterdam: 20.00 – 22.00h

Party ss Rotterdam: 22.00 – 01.00h

Transfer every hour from ss Rotterdam to De Doelen from 22.00h

### **Friday**

*Lunch:* 12.00 – 13.00h Willem Burger Foyer

## **Assemblies**

### **Thursday March 15, 2018**

Assembly Nederlandse Transplantatie Vereniging 17.30  
*Locatie: Willem Burgerzaal*

Assembly Belgium Transplantation Society 17.30  
*Location: Van Weelde Zaal*

**Program schedule**  
**Thursday morning March 15th 2018**

<b>Thursday</b>	<b>Willem Burger Zaal</b>			
9.45 – 9.55	Welcome: Carla Baan, Chair of the Local Organising Committee			
9.55 – 11.00	<p><i>Plenary session 1: Borders crossed</i></p> <p>Introduction of the Belgium and Dutch transplantation programs <i>Olivier Detry (Liège, Belgium) and Marlies Reinders (Leiden, The Netherlands)</i></p> <p>Organ transplantation from a historical perspective: breakthroughs and current challenges <i>Liver: Jean Bernard Otte, (Louvain, Belgium); Kidney: Willem Weimar (Rotterdam, The Netherlands)</i></p> <p>Immunosuppression – meeting unmet needs <i>Teun van Gelder (Rotterdam, The Netherlands)</i></p>			
11.00 – 11.30	Coffee break			
	<b>Van Weelde Zaal</b>	<b>Willem Burger Zaal</b>	<b>Van de Vorm/Plate Zaal</b>	<b>Van Rijck/Ruys Zaal</b>
11.30 – 13.00	<i>Parallel session 2:</i> Basic / translational research	<i>Parallel session 3:</i> Clinical	<i>Parallel session 4:</i> Nursing (talks will be in Dutch, translators available)	<i>Parallel session 5:</i> Clinical
13.00 – 14.00	Lunch break			
	<b>Van Weelde Zaal</b>			
13.00 – 14.00	<p><i>Teaching session:</i> ‘Recent advances in Xenotransplantation’ <i>Heiner Niemann, Friedrich-Loeffler-Institut, Neustadt</i></p> <p>‘Autophagy in Transplantation – Cleaning up the Cellular Mess in Organ Grafts’ <i>Jean-Paul Decuypere, KUL Leuven</i></p>			

**Program schedule**  
**Thursday afternoon March 15th 2018**

<b>Thursday</b>	<b>Willem Burger Zaal</b>				
14.00 – 15.15	<p><i>Plenary session 6: New and different borders</i></p> <p>Improving deceased organ donation - present and future: <i>Henri Leuvenink (Groningen, The Netherlands)</i>  Organ donation after euthanasia: <i>Dirk Ysebaert (Antwerp, Belgium)</i>  Non heart beating donor heart transplantation: Challenges and opportunities: <i>Olivier Manintveld (Rotterdam, The Netherlands)</i>  Ethical dilemmas in medical research: <i>Annelien Bredenoord (Utrecht, The Netherlands)</i></p>				
	<b>Willem Burger Foyer</b>				
15.15 – 15.45	<i>Poster session 1:</i> Nursing	<i>Poster session 2:</i> Clinical	<i>Poster session 3:</i> Clinical	<i>Poster session 4:</i> Basic/translational research	<i>Poster session 5:</i> Donation
15.45 – 16.15	Coffee break				
	<b>Van Weelde Zaal</b>	<b>Willem Burger Zaal</b>	<b>Van der Vorm/Plate Zaal</b>	<b>Van Rijck/Ruys Zaal</b>	
16.15 – 17.15	<i>Parallel session 7:</i> Basic / translational research	<i>Parallel session 8:</i> Clinical	<i>Parallel session 9:</i> Nursing (talks will be in Dutch, translators available)	<i>Parallel session 10:</i> Transplant coordination	
	<b>Willem Burger Zaal</b>		<b>Van Weelde Zaal</b>		
17.30 – 18.30	General Assembly NTV		General Assembly BTS		
19.00 – 20.00	Transfer with buses from De Doelen to the ss Rotterdam				
20.00 – 01.00	Social evening at the ss Rotterdam				

**Program schedule**  
**Friday morning March 16th 2018**

<b>Friday</b>	<b>Willem Burger Zaal</b>			
09.00 – 10.00	<i>Plenary 11: Crossing borders in basic &amp; translational science</i>  The Emerging Role of DNA Methylation in Kidney Transplantation: A Perspective: <i>Line Heylen (Leuven, Belgium)</i> Implementation of miRNAs as predictors of rejection into daily practice: <i>Abraham Shaked (Philadelphia, USA)</i> iBOX a next step to predicting long-term allograft failure: <i>Alexander Loupy (Paris, France)</i>			
10.00 – 10.30	Coffee break and poster session II			
	<b>Willem Burger Foyer</b>			
10.00 – 10.30	<i>Poster session 6:</i> Clinical	<i>Poster session 7:</i> Clinical	<i>Poster session 8:</i> Basic	<i>Poster session 9:</i> Donation
	<b>Van Weelde Zaal</b>	<b>Willem Burger Zaal</b>	<b>Van der Vorm/Plate Zaal</b>	<b>V Rijck/Ruys Zaal</b>
10.30 – 12.00	<i>Parallel session 12:</i> Basic/translational research	<i>Parallel session 13:</i> Clinical	<i>Parallel session 14:</i> Transplant coordination casus session	<i>Parallel session 15:</i> Clinical
12.00 – 13.00	Lunch break			

**Program schedule  
Friday afternoon March 16th 2018**

<b>Friday</b>	<b>Willem Burger Zaal</b>		
13.00 – 14.00	<i>Plenary session 16: Same borders for doctors and patients? (patiënten zijn welkom bij deze sessie)</i>		
	<b>V Rijck/Ruys Zaal</b>	<b>Willem Burger Zaal</b>	<b>Van Weelde Zaal</b>
14.00 – 15.15	<i>Parallel session 17: Young Professionals in Transplantation</i>	<i>Parallel session 18: Clinical</i>	<i>Parallel session 19 Nierteam aan huis Patiënten zijn welkom bij deze sessie</i>
15.15 – 15.45	Coffee break		
	<b>Willem Burger Zaal</b>		
15.45 – 16.30	Award session – Jon van Rood Award NTV and Belgium best PhD award		
16.30 – 16.45	Closing by Carla Baan, Chair of the Local Organising Committee		

Thursday, March 15<sup>th</sup>, 2018

---

**Plenary Session I**

**Willem Burger Zaal**

---

*Chairs: Prof. dr. Marlies E.J. Reinders, President NTV, nephrologist, LUMC  
Prof. dr. Oliver Detry, President BTS, Transplant Surgeon, ULG*

**Topic: Borders crossed**

*Language: English*

09.45 Welcome  
*Prof. dr. Carla C. Baan, Erasmus MC, Rotterdam, The Netherlands*

09.55 Introduction of the Belgium and Dutch transplantation programs  
*Prof. dr. Olivier Detry, ULG, Liège, Belgium  
Prof. dr. Marlies Reinders, LUMC, Leiden, The Netherlands*

10.15 Organ transplantation from a historical perspective:  
Breakthroughs and current challenges  
*Liver: Prof. dr. Jean Bernard Otte, UCL, Louvain-en-Woluwe, Belgium  
Kidney: Prof. dr. Willem Weimar, Erasmus MC, Rotterdam,  
The Netherlands*

10.45 Immunosuppression – meeting unmet needs  
*Prof. dr. Teun van Gelder, Erasmus MC, Rotterdam, The Netherlands*

11.00 Coffee break



Thursday, March 15<sup>th</sup>, 2018

---

**Parallel session 2 - Basic / translational research Van Weelde Zaal**

---

Chairs: to be announced

Language: English, presentation time 7 min., discussion 3 min.

- 11.30 Bile duct regeneration: Characterization of human bile duct derived organoids  
K. Burka<sup>1</sup>, M.M.A. Verstegen<sup>1</sup>, H.P. Roest<sup>1</sup>, M. de Wolf<sup>1</sup>, M.J.C. Bijvelds<sup>2</sup>, H. Gehart<sup>3</sup>, J. de Jonge<sup>1</sup>, H.R. de Jonge<sup>2</sup>, J.N.M. Ijzermans<sup>1</sup>, L.J.W. van der Laan<sup>1</sup>. <sup>1</sup>Dept. of Surgery, Erasmus Medical Center, Rotterdam. <sup>2</sup>Dept. of Gastroenterology, Erasmus Medical Center, Rotterdam. <sup>3</sup>Hubrecht Institute, Utrecht, The Netherlands.
- 11.40 Mitochondrial Damage-Associated Molecular Patterns (MTDs) Released from Hepatic Ischemia and Reperfusion Induce Inflammatory Responses  
Q. Hu<sup>1</sup>, L. Westhaver<sup>1</sup>, J. Marshall<sup>2</sup>, I.P.J. Alwayn<sup>3</sup>. <sup>1</sup>Dept. of Pathology, Dalhousie University, Halifax, Canada. <sup>2</sup>Dept. of Microbiology & Immunology, Dalhousie University, Halifax, Canada. <sup>3</sup>Dept. of Transplant Surgery, LUMC, Leiden, The Netherlands.
- 11.50 Urinary C5b-9 is an Independent Predictor of Graft Failure in Renal Transplant Recipients  
R.G.M. Lammerts, M.F. Eisenga, M. Alyami, M.A.J. Seelen, M.R. Daha, J. van den Born, S.J.L. Bakker, S.P. Berger, on behalf of the COMBAT Consortium. Dept. of Nephrology, University Medical Center Groningen, Groningen, The Netherlands.
- 12.00 Immunomodulation by therapeutic mesenchymal stromal cells (MSC) is triggered through phagocytosis of MSC by monocytic cells  
J.M. Sierra Parraga<sup>1</sup>, S.F.H. De Witte<sup>1</sup>, F. Luk<sup>1</sup>, M. Gargasha<sup>2</sup>, A. Merino<sup>3</sup>, S.S. Korevaar<sup>4</sup>, A.S. Shankar<sup>1</sup>, L. O'Flynn<sup>5</sup>, S.J. Elliman<sup>5</sup>, D. Roy<sup>2</sup>, M.G.H. Betjes<sup>3</sup>, P.N. Newsome<sup>6</sup>, C.C. Baan<sup>3</sup>, M.J. Hoogduijn<sup>3</sup>. <sup>1</sup>Dept. of Internal Medicine, Erasmus Medical Center, Rotterdam, The Netherlands. <sup>2</sup>Bio-InVision Inc, Mayfield village, Ohio, United States of America. <sup>3</sup>Dept. of internal Medicine, Erasmus Medical Center, Rotterdam, The Netherlands.

Thursday, March 15<sup>th</sup>, 2018

<sup>4</sup>Dept. of Nephrology and Transplantation, Erasmus Medical Center, Rotterdam, The Netherlands. <sup>5</sup>Orbsen Therapeutics Ltd, Galway, Ireland. <sup>6</sup>Liver Biomedical Research Unit at University Hospitals Birmingham, Birmingham, The Netherlands.

- 12.10 Impact of different dynamic preservation strategies on early renal function and physical machine perfusion parameters in a porcine DCD auto-transplant model  
*T. Darius<sup>1</sup>, P. Gianello<sup>2</sup>, A. Buemi<sup>1</sup>, M. De Meyer<sup>1</sup>, M. Mourad<sup>1</sup>. <sup>1</sup>Dept. of Surgery and Abdominal Transplant Unit, University Clinics Saint Luc, Brussels, Belgium. <sup>2</sup>Pôle de Chirurgie Expérimentale et Transplantation, Université catholique de Louvain, Brussels, Belgium.*
- 12.20 Towards graft engineering using decellularized porcine liver scaffolds and recellularization with human liver organoids  
*J. Willemse, M.M.A. Verstegen, L.J.W. Van der Laan, J. De Jonge. Dept. of surgery, Erasmus Medical Center, Rotterdam, The Netherlands*
- 12.30 Tranilast pre-treatment attenuates intestinal ischemia reperfusion injury  
*E. Canovai<sup>1</sup>, L. Ceulemans<sup>1</sup>, T. Vanuytsel<sup>2</sup>, G. de Hertogh<sup>1</sup>, R. Farré<sup>3</sup>, T. Vanuytsel<sup>1</sup>. <sup>1</sup>Leuven Intestinal Failure and Transplantation Center, UZ Leuven, Leuven, <sup>2</sup>Leuven Intestinal Failure and Transplantation Center, Leuven, <sup>3</sup>Translationeel Onderzoek van Gastro-enterologische Aandoeningen, KU Leuven, Leuven, Belgium.*
- 12.40 MicroRNA-126 measurements in right ventricular endomyocardial biopsies of heart transplant recipients with and without cardiac allograft vasculopathy  
*W.A. Heggermont, L. Delrue, K. Dierickx, J. Bartunek, M. Vanderheyden. Cardiovascular Research Center, OLV Hospital Aalst, Aalst, Belgium.*
- 12.50 Renal allograft transcription analysis with NanoString<sup>®</sup> nCounter<sup>®</sup> analysis system reveals similar signature of acute T cell mediated rejection in patients treated with tacrolimus or belatacept  
*M. Van der Zwan<sup>1</sup>, C.C. Baan<sup>1</sup>, R.B. Colvin<sup>2</sup>, R.N. Smith<sup>2</sup>, R.A. White<sup>2</sup>, D. Ndishibandi<sup>2</sup>, G.N. De Graav<sup>1</sup>, M.C. Clahsen-van Groningen<sup>3</sup>, D.A. Hesselink<sup>1</sup>. <sup>1</sup>Dept. of internal medicine, Erasmus Medical Center, Rotterdam, The Netherlands. <sup>2</sup>Dept. of pathology, Massachusetts General Hospital/Harvard Medical School, Massachusetts, United States of America. <sup>3</sup>Dept. of pathology, Erasmus Medical Center, Rotterdam, The Netherlands.*

Thursday, March 15<sup>th</sup>, 2018

13.00 Lunch break and teaching session

---

**Parallel session 3 – Clinical**

**Willem Burger Zaal**

---

Chairs: to be announced

Language: English, presentation time 7 min., discussion 3 min.

- 11.30 New ways of reporting on Dutch kidney transplantations  
M.B.A. Heemskerk<sup>1</sup>, A.J. Hoitsma<sup>1</sup>, F.J. van Ittersum<sup>2</sup>, A.P.J. de Vries<sup>3</sup>, A.D. van Zuilen<sup>4</sup>, S.P. Berger<sup>5</sup>. <sup>1</sup>Dutch Transplant Foundation, Leiden. <sup>2</sup>Dept. of nephrology, VU University Medical Center, Amsterdam. <sup>3</sup>Leiden Transplant Center, Leiden University Medical Center, Leiden. <sup>4</sup>Dept. of nephrology, University Medical Center Utrecht, Utrecht. <sup>5</sup>Dept. of nephrology, University Medical Center Groningen, Groningen, The Netherlands.
- 11.45 Shifting paradigms in Intestinal Transplantation: from rescue therapy to standard treatment?  
E. Canovai<sup>1</sup>, L. Ceulemans<sup>1</sup>, I. Hoffman<sup>2</sup>, G. de Hertogh<sup>1</sup>, M. Hiele<sup>1</sup>, M. Sainz-Bariga<sup>1</sup>, D. Monbaliu<sup>1</sup>, I. Jochmans<sup>1</sup>, T. Vanuytsel<sup>1</sup>, J. Pirenne<sup>1</sup>. <sup>1</sup>Leuven Intestinal Failure and Transplantation Center, UZ Leuven, Leuven, Belgium. <sup>2</sup>Pediatric Dept., UZ Leuven, Leuven, Belgium.
- 11.55 Time needed for removal of the liver after in situ cold perfusion in donation after circulatory death donors is an independent risk factor for the development of biliary strictures and early graft loss after transplantation  
O.B. van Leeuwen<sup>1</sup>, M. van Reeve<sup>2</sup>, M. Fujiyoshi<sup>1</sup>, V.E. de Meijer<sup>1</sup>, R.H.J. de Kleine<sup>1</sup>, M.T. de Boer<sup>1</sup>, J. de Jonge<sup>2</sup>, J.N.M. Ijzermans<sup>2</sup>, W.G. Polak<sup>2</sup>, R.J. Porte<sup>1</sup>. <sup>1</sup>Dept. of Surgery, University Medical Center Groningen, Groningen. <sup>2</sup>Dept. of Surgery, Erasmus Medical Center, Rotterdam, The Netherlands.
- 12.05 Combined Calorie and Protein Restriction in Live Kidney Donors Improves Kidney Function in Both Donors and Transplant Recipients  
F. Jongbloed<sup>1</sup>, R.W.F. de Bruin<sup>1</sup>, P. Beekhof<sup>2</sup>, P. Wackers<sup>2</sup>, D.A. Hesselink<sup>3</sup>,

Thursday, March 15<sup>th</sup>, 2018

H. van Steeg<sup>2</sup>, J.H.J. Hoeijmakers<sup>4</sup>, M.E.T. Dollé<sup>5</sup>, J.N.M. IJzermans<sup>1</sup>. <sup>1</sup>Dept. of Surgery, Erasmus Medical Center, Rotterdam. <sup>2</sup>National Institute for Public Health and the Environment, Bilthoven. <sup>3</sup>Dept. of Internal Medicine, Erasmus Medical Center, Rotterdam. <sup>4</sup>Dept. of Genetics, Erasmus Medical Center, Rotterdam. <sup>5</sup>National Institute for Public Health and the Environment, Bilthoven, The Netherlands.

12.15 The impact of cold ischemia time on outcomes of deceased donor kidney transplantation: does every hour count?

H. Peters-Sengers<sup>1</sup>, J.H.E. Houtzager<sup>2</sup>, M.M. Idu<sup>2</sup>, M.B.A. Heemskerk<sup>3</sup>, L.W.E. van Heurn<sup>4</sup>, J.J. Homan van der Heide<sup>5</sup>, S.P. Berger<sup>6</sup>, J. Kers<sup>7</sup>, T.M. van Gulik<sup>2</sup>, F.J. Bemelman<sup>5</sup>. <sup>1</sup>Dept. of Nephrology, Academic Medical Center, Amsterdam. <sup>2</sup>Dept. of Surgery, Academic Medical Center, Amsterdam. <sup>3</sup>Dutch Transplant Foundation, Leiden. <sup>4</sup>Dept. of Paediatric Surgery, Academic Medical Center, Amsterdam. <sup>5</sup>Dept. of Nephrology, Academic Medical Center, Amsterdam. <sup>6</sup>Dept. of Nephrology, University Medical Center Groningen, Groningen. <sup>7</sup>Dept. of Pathology, Academic Medical Center, Amsterdam, The Netherlands.

12.25 Improved risk stratification of pretransplant donor specific Antibodies with epitope analyses

E.G. Kamburova<sup>1</sup>, B.W. Wisse<sup>1</sup>, A. van der Meer<sup>2</sup>, W.A. Allebes<sup>2</sup>, I. Joosten<sup>2</sup>, L.B. Hilbrands<sup>3</sup>, M.C. Baas<sup>3</sup>, E. Spierings<sup>1</sup>, C.E. Hack<sup>1</sup>, F.E. van Reekum<sup>4</sup>, A.D. van Zuilen<sup>4</sup>, M.C. Verhaar<sup>4</sup>, M.L. Bots<sup>5</sup>, A.C.A.D. Drop<sup>1</sup>, L. Plaisier<sup>1</sup>, M.A.J. Seelen<sup>6</sup>, J.S.F. Sanders<sup>6</sup>, B.G. Hepkema<sup>7</sup>, A.J. Lambeck<sup>7</sup>, L.B. Bungener<sup>7</sup>, C. Roozendaal<sup>7</sup>, M.G.J. Tilanus<sup>8</sup>, C.E. Voorter<sup>8</sup>, L. Wieten<sup>8</sup>, E.M. van Duijnhoven<sup>9</sup>, M. Gelens<sup>9</sup>, M.H.L. Christiaans<sup>9</sup>, F.J. van Ittersum<sup>10</sup>, A. Nurmohamed<sup>10</sup>, N.M. Lardy<sup>11</sup>, W. Swelsen<sup>11</sup>, K.A. van der Pant<sup>12</sup>, N.C. van der Weerd<sup>12</sup>, I.J.M. ten Berge<sup>12</sup>, F.J. Bemelman<sup>12</sup>, A. Hoitsma<sup>13</sup>, P.J.M. van der Boog<sup>14</sup>, J.W. de Fijter<sup>14</sup>, M.G.H. Betjes<sup>15</sup>, S. Heidt<sup>16</sup>, D.L. Roelen<sup>16</sup>, F.H. Claas<sup>16</sup>, <sup>1</sup>Laboratory of Translational Immunology, University Medical Center Utrecht, Utrecht. <sup>2</sup>Laboratory Medicine, Lab. Medical Immunology, Radboud University Medical Center, Nijmegen. <sup>3</sup>Dept. of Nephrology, Radboud University Medical Center, Nijmegen. <sup>4</sup>Dept. of Nephrology, University Medical Center Utrecht, Utrecht. <sup>5</sup>Julius Center for Health Sciences and Primary Care, University Medical Center Utrecht, Utrecht. <sup>6</sup>Dept. of Nephrology, University of Groningen, UMC Groningen, Groningen. <sup>7</sup>Dept. of Laboratory Medicine, University of Groningen, UMCG, Groningen. <sup>8</sup>Dept. of Transplantation Immunology, Tissue Typing Laboratory, Maastricht UMC, Maastricht. <sup>9</sup>Dept. of Internal Medicine, Division of Nephrology, Maastricht UMC, Maastricht. <sup>10</sup>Dept. of Nephrology, VU

Thursday, March 15<sup>th</sup>, 2018

University Medical Center, Amsterdam. <sup>11</sup>Dept. of Immunogenetics, Sanquin, Amsterdam. <sup>12</sup>Renal Transplant Unit, Dept. of Internal Medicine, Academic Medical Center, Amsterdam. <sup>13</sup>Dutch Organ Transplant Registry (NOTR), Dutch Transplant Foundation (NTS), Leiden. <sup>14</sup>Dept. of Nephrology, Leiden University Medical Center, Leiden. <sup>15</sup>Dept. of Internal Medicine, Nephrology, Erasmus MC University Medical Center, Rotterdam. <sup>16</sup>Dept. of Immunohematology and Blood Transfusion, Leiden UMC, Leiden, The Netherlands.

- 12.35 Double J is superior to externally draining ureteric stent in enhancing recovery after living donor kidney transplantation  
M.H.D. Bruintjes<sup>1</sup>, F.C.H. d' Ancona<sup>2</sup>, J.C.M. Kusters<sup>2</sup>, L.B. Hilbrands<sup>3</sup>, M.C. Warlé<sup>1</sup>. <sup>1</sup>Dept. of Surgery, Radboud University Medical Center, Nijmegen. <sup>2</sup>Dept. of Urology, Radboud University Medical Center, Nijmegen. <sup>3</sup>Dept. of Nephrology, Radboud University Medical Center, Nijmegen, The Netherlands.
- 12.45 The rise in serum creatinine shortly after kidney donation is correlated with skeletal muscle mass as measured by CT image analysis.  
L.C. van Laar<sup>1</sup>, S.A. Nurmohamed<sup>1</sup>, A. van der Werf<sup>2</sup>, T. Hoekstra<sup>1</sup>, J.W. van der Heijden<sup>3</sup>. <sup>1</sup>Dept. of Nephrology, VU University Medical Center, Amsterdam. <sup>2</sup>Dept. of nutrition and dietetics, VU University Medical Center, Amsterdam. <sup>3</sup>Dept. of Nephrology, VU University Medical Center, Amsterdam, The Netherlands.
- 13.00 Lunch break and teaching session

Thursday, March 15<sup>th</sup>, 2018

---

**Parallel session 4 – Nursing**

**Van der Vorm/Plate Zaal**

---

**Chairs:** *Louise Maasdam, verpleegkundig specialist, Erasmus MC , Rotterdam*  
*Lara van Elshove, verpleegkundig specialist, Erasmus MC Rotterdam*

**Spreektaal:** *Nederlands.*

**11.30**      **Opening**

**11.35**      **Presentatie Winnaar Innovatie Kwaliteitsprijs 2017:**  
*Marleen van Buren, verpleegkundig specialist,*  
*Erasmus MC, Rotterdam, NL*

**11.50**      **Keynote presentatie I:**  
**Ziekenhuis infectiepreventie in België**  
*Carine Breunig, verpleegkundige UZ Leuven, België*  
*Mathilde Dehairs, verpleegkundige UZ Leuven, België*

**Keynote presentatie II:**  
**Ziekenhuis infectiepreventie in Nederland**  
*Femke Mollema, internist-infectioloog, Erasmus MC Rotterdam, NL*

**12.50**      **Samenvatting**

**13.00**      **Lunch break and teaching session**

Chairs: to be announced

Language: English, presentation time 7 min., discussion 3 min.

- 11.30 Resuscitation and viability testing of initially declined livers using sequential hypo- and normothermic machine perfusion with an acellular fluid: First results of the DHOPE-COR-NMP Trial  
Y. de Vries<sup>1</sup>, A.P.M. Matton<sup>1</sup>, S.A. Karangwa<sup>1</sup>, O.B. van Leeuwen<sup>1</sup>, M.W.N. Nijsten<sup>2</sup>, H.J. de Kleine<sup>1</sup>, A.P. van den Berg<sup>3</sup>, H. Blokzijl<sup>3</sup>, F. van der Heide<sup>3</sup>, V.E. de Meijer<sup>1</sup>, T.C.M.A. Schreuder<sup>3</sup>, P. Meyer<sup>4</sup>, M. Fujiyoshi<sup>1</sup>, M.T. de Boer<sup>1</sup>, R.J. Porte<sup>1</sup>. <sup>1</sup>Dept. of Surgery, University Medical Center Groningen, Groningen. <sup>2</sup>Dept. of Clinical Care, University Medical Center Groningen, Groningen. <sup>3</sup>Dept. of Gastroenterology and Hepatology, University Medical Center Groningen, Groningen. <sup>4</sup>Dept. of Anesthesiology, University Medical Center Groningen, Groningen, The Netherlands.
- 11.40 Immunosuppressive drug withdrawal late after liver transplantation leads to an improvement of lipid metabolism and liver function  
A.A. Duizendstra<sup>1</sup>, R.J. de Knecht<sup>1</sup>, M.G.H. Betjes<sup>2</sup>, S. Coenen<sup>1</sup>, S. Darwish Murad<sup>1</sup>, R.A. de Man<sup>1</sup>, H.J. Metselaar<sup>3</sup>, N.H.R. Litjens<sup>4</sup>, J. Kwekkeboom<sup>1</sup>. <sup>1</sup>Dept. Gastroenterology and Hepatology, Erasmus medical center, Rotterdam. <sup>2</sup>Dept. Internal Medicine div Nefrology and Transplantation, Erasmus medical center, Rotterdam. <sup>3</sup>Dept. of Gastroenterology and Hepatology, Erasmus medical center, Rotterdam. <sup>4</sup>Dept. Internal Medicine div Nefrology and Transplantation, Erasmus medical Center, Rotterdam, The Netherlands.
- 11.50 Production of Physiologically Relevant Quantities of Hemostatic Proteins During Normothermic Machine Perfusion of Human Livers.  
S.A. Karangwa<sup>1</sup>, J. Adelmeijer<sup>2</sup>, A.P.M. Matton<sup>1</sup>, V.E. de Meijer<sup>1</sup>, J.A. Lisman<sup>1</sup>, R.J. Porte<sup>1</sup>. <sup>1</sup>Section of HPB Surgery and Liver Transplantation, Dept. of Surgery, UMCG, Groningen. <sup>2</sup>Surgical Research Laboratory, Dept. of Surgery UMCG, Groningen, The Netherlands.

Thursday, March 15<sup>th</sup>, 2018

- 12.00 Phenotype and long-term outcome of the patients with histology of ABMR but without detectable donor-specific HLA antibodies  
A. Senev<sup>1</sup>, V. van Sandt<sup>1</sup>, L. Daniëls<sup>1</sup>, E. Lerut<sup>2</sup>, D. Kuypers<sup>3</sup>, M. Coemans<sup>4</sup>, M.P. Emonds<sup>1</sup>, M. Naesens<sup>3</sup>. <sup>1</sup>Histocompatibility and Immunogenetics Laboratory, Belgian Red Cross-Flanders, Mechelen. <sup>2</sup>Dept. of Pathology, University Hospitals Leuven, Leuven. <sup>3</sup>Dept. of Nephrology and Renal Transplantation, University Hospitals Leuven, Leuven. <sup>4</sup>Dept. of Microbiology and Immunology, KU Leuven, Leuven, Belgium.
- 12.10 Predictors for Adverse Pregnancy Outcomes in the Dutch Renal Transplant Population  
M.E. Gosselink<sup>1</sup>, M. van Buren<sup>2</sup>, T.K.J. Groenhof<sup>3</sup>, H. Van Hamersvelt<sup>4</sup>, J. van de Wetering<sup>5</sup>, A.T. Lely<sup>1</sup>. <sup>1</sup>Dept. of Obstetrics and Gynaecology, University Medical Center Utrecht, Utrecht. <sup>2</sup>Dept. of Internal medicine, Erasmus Medical Center, Rotterdam. <sup>3</sup>Dept. of Epidemiology Julius Center, University Medical Center Utrecht, Utrecht. <sup>4</sup>Dept. of Nephrology, Radboud University Medical Center, Nijmegen. <sup>5</sup>Dept. of Nephrology, Erasmus Medical Center, Rotterdam, The Netherlands.
- 12.20 Favorable outcomes after heart transplantation in children: 18 years' experience of the national Dutch program at Erasmus MC.  
S. Roest<sup>1</sup>, M.H. van der Meulen<sup>2</sup>, U.S. Kraemer<sup>3</sup>, M. van Osch-Gevers<sup>2</sup>, P.C. van de Woestijne<sup>4</sup>, A.J.J.C. Bogers<sup>4</sup>, M. Dalinghaus<sup>2</sup>. <sup>1</sup>Dept. of Cardiology, Erasmus MC, University Medical Center, Rotterdam. <sup>2</sup>Dept. of Pediatric Cardiology, Erasmus MC-Sophia's Children's Hospital, Rotterdam. <sup>3</sup>Dept. of Pediatric Intensive Care, Erasmus MC-Sophia's Children's Hospital, Rotterdam. <sup>4</sup>Dept. of Cardio-thoracic Surgery, Erasmus Medical Center, Rotterdam, The Netherlands.
- 12.30 Successful clinical experience with extended normothermic ex-vivo lung perfusion (> 8 hours)  
L.J. Ceulemans<sup>1</sup>, A. Neyrinck<sup>2</sup>, R. Vos<sup>3</sup>, A. Stanzi<sup>1</sup>, M. Boada<sup>1</sup>, A. Martens<sup>2</sup>, S. Ordies<sup>2</sup>, K. Degezelle<sup>4</sup>, G. Verleden<sup>3</sup>, D. Van Raemdonck<sup>1</sup>. <sup>1</sup>Thoracic Surgery, University Hospitals Leuven, Leuven. <sup>2</sup>Anesthesiology, University Hospitals Leuven, Leuven. <sup>3</sup>Pneumology, University Hospitals Leuven, Leuven. <sup>4</sup>Perfusion, University Hospitals Leuven, Leuven, Belgium.
- 12.40 The evolution of pediatric liver transplantation in the Netherlands over the past two decades  
M.J.M. Werner<sup>1</sup>, R.H.J. de Kleine<sup>1</sup>, F.A.J.A. Bodewes<sup>2</sup>, M.T. de Boer<sup>1</sup>, K.P. de Jong<sup>1</sup>, V.E. de Meijer<sup>1</sup>, R. Scheenstra<sup>2</sup>, E. Sieders<sup>1</sup>, H.J. Verkade<sup>2</sup>, R.J.



Thursday, March 15<sup>th</sup>, 2018

Porte<sup>1</sup>. <sup>1</sup>Dept. of Hepatobiliary Surgery and Liver Transplantation, UMC Groningen, Groningen. <sup>2</sup>Dept. of Pediatric Gastroenterology and Hepatology, UMC Groningen, Groningen, The Netherlands.

12.50 Predictive Value of Right Heart Hemodynamics for Acute Kidney Injury After Heart Transplantation

G. Guven<sup>1</sup>, M. Brankovic<sup>1</sup>, A. Constantinescu<sup>1</sup>, J. Brugts<sup>1</sup>, D. Hesselink<sup>2</sup>, S. Akin<sup>1</sup>, A. Struijs<sup>3</sup>, O. Birim<sup>4</sup>, C. Ince<sup>3</sup>, O. Manintveld<sup>1</sup>, K. Caliskan<sup>1</sup>. <sup>1</sup>Dept. of Cardiology, Erasmus Medical Center, Rotterdam. <sup>2</sup>Dept. of Internal Medicine, Erasmus Medical Center, Rotterdam. <sup>3</sup>Dept. of Intensive Care, Erasmus Medical Center, Rotterdam. <sup>4</sup>Dept. of Cardiothoracic Surgery, Erasmus Medical Center, Rotterdam, The Netherlands.

13.00 Lunchbreak and teaching session

---

**Teaching session**

**Van Weelde Zaal**

---

*Chairs:* Prof. dr. Henri Leuvenink, scientist, UMC Groningen  
Dr. Coby H. Annema-de Jong, senior researcher, UMC Groningen

*Language:* English

13.00 'Recent advances in Xenotransplantation'  
Prof. dr. Heiner Niemann, Friedrich-Loeffler-Institut, Neustadt

'Autophagy in Transplantation – Cleaning up the Cellular Mess in Organ Grafts'  
Prof. dr. Jean-Paul Decuyper, KUL Leuven

14.00 End of teaching session

Thursday, March 15<sup>th</sup>, 2018

---

**Plenary session 6**

**Willem Burger Zaal**

---

Chairs: *to be announced*

**Thema: New and different Borders**

Language: *English*

- 14.00      Improving deceased organ donation – present and future  
*Prof. dr. Henri Leuvenink, UMC Groningen*
- 14.15      Organ Donation after Euthanasia  
*Prof. dr. Dirk Ysebaert, Antwerp University Hospital, Antwerp*
- 14.30      Non heart beating donor heart transplantation:  
Challenges and opportunities  
*Dr. Olivier Manintveld, Erasmus MC, Rotterdam*
- 14.45      Ethical Dilemmas in medical research  
*Prof. dr. Annelien Bredenoord, UMCU and member house of Parliament  
(Eerste kamer der staten generaal)*
- 15.15      Moderated poster sessions in Willem Burger Foyer
- 15.45      Coffee break

Moderator: to be announced

Spreektaal: Nederlands, spreektijd 3 minuten, discussietijd 2 minuten.

**15.15 - 15.35**

1. Promoting Medication Adherence and Self-management among kidney transplant recipients (MARS-trial): the development of an intervention protocol  
*D.K. Beck<sup>1</sup>, M. Tielen<sup>1</sup>, S. Ismail<sup>2</sup>, J. van de Wetering<sup>1</sup>, T. van Gelder<sup>1</sup>, C. Boonstra<sup>2</sup>, J. Versteegh<sup>3</sup>, K. Cransberg<sup>3</sup>, W. Weimar<sup>1</sup>, J.J. van Busschbach<sup>2</sup>, J.L.C.M. van Saase<sup>1</sup>, E.K. Massey<sup>1</sup>. <sup>1</sup>Dept. of Internal Medicine, Erasmus Medical Center, Rotterdam. <sup>2</sup>Dept. of Medical Psychology & Psychotherapy, Erasmus Medical Center, Rotterdam. <sup>3</sup>Dept. of Pediatric Nephrology, Erasmus Medical Center - Sophia Childrens Hospital, Rotterdam, The Netherlands.*
2. Familieparticipatie bij levertransplantatie patiënten  
*D.M. Gosker-Epskamp<sup>1</sup>, L.M.N. With de<sup>1</sup>. <sup>1</sup>Dept of HPB Surgery and livertransplant, UMCG, Groningen, The Netherlands.*
3. Levende nierdonatie: hoe tevreden zijn de donoren?  
*H.J. Kloke<sup>1</sup>, C. van de Weerd<sup>1</sup>, D.B. Pilzecker<sup>1</sup>, C.W. Hooghof<sup>1</sup>, F.C.H. D'Ancona<sup>2</sup>, J.F. Langenhuijsen<sup>2</sup>, J.C.M. Kusters<sup>2</sup>, E.M. Ommen<sup>1</sup>, P.H.M.M. Dooper<sup>1</sup>. <sup>1</sup>Dept. of Nephrology, Radboud University Medical Center, Nijmegen. <sup>2</sup>Dept. of Urology, Radboud University Medical Center, Nijmegen, The Netherlands.*
4. The ELPAT living organ donor Psychosocial Assessment Tool (EPAT): from 'what' to 'how' of psychosocial screening  
*E.K. Massey<sup>1</sup>, L. Timmerman<sup>1</sup>, S.Y. Ismail<sup>2</sup>, N. Duerinckx<sup>3</sup>, A. Lopes<sup>4</sup>, H. Maple<sup>5</sup>, I. Mega<sup>6</sup>, C. Papachristou<sup>7</sup>, F. Dobbels<sup>3</sup>. <sup>1</sup>Dept. of Internal Medicine, Erasmus MC, Rotterdam, The Netherlands. <sup>2</sup>Dept. of Psychiatry, Erasmus MC, Rotterdam, The Netherlands. <sup>3</sup> Dept. of Public Health and Primary Care, KU Leuven, Leuven, Belgium. <sup>4</sup>Centro Hospitalar do Porto, Porto, Portugal. <sup>5</sup>Guy's and St. Thomas NHS, London, United Kingdom. <sup>6</sup>Hospital Curry Cabral, Lisbon, Portugal. <sup>7</sup>Dept. of Psychosomatic Medicine, Charité-Universitätsmedizin, Berlin, Germany.*

*Moderator: to be announced*

*Language: English, presentation time 3 min., discussion 2 min.*

**15.15 - 15.45**

5. Urological complications following renal transplantation: a cohort study  
*M.H.D. Bruintjes<sup>1</sup>, F.C.H. d' Ancona<sup>2</sup>, R.A.R.T. Donders<sup>3</sup>, A.J. Hoitsma<sup>4</sup>, M.C. Warlé<sup>1</sup>. <sup>1</sup>Dept. of Surgery, Radboud University Medical Center, Nijmegen. <sup>2</sup>Dept. of Urology, Radboud University Medical Center, Nijmegen. <sup>3</sup>Dept. for Health Evidence, Radboud University Medical Center, Nijmegen. <sup>4</sup>Dept. of Nephrology, Radboud University Medical Center, Nijmegen, The Netherlands.*
  
6. The changing epidemiology of deceased liver donors in adult liver transplantation  
*L.M. Nieuwenhuis<sup>1</sup>, M. van Londen<sup>2</sup>, M.T. de Boer<sup>1</sup>, R.H.J. de Kleine<sup>1</sup>, A.P. van den Berg<sup>3</sup>, H. Blokzijl<sup>3</sup>, R.J. Porte<sup>4</sup>, V.E. de Meijer<sup>1</sup>. <sup>1</sup>Dept. of HPB Surgery and Liver Transplantation, UMC Groningen, Groningen. <sup>2</sup>Dept. of Internal Medicine, University Medical Center Groningen, Groningen. <sup>3</sup>Dept. of Gastroenterology and Hepatology, UMC Groningen, Groningen. <sup>4</sup>Dept. of HPB and Liver Transplantation, UMC Groningen, Groningen, The Netherlands.*
  
7. The changing epidemiology of liver donors in pediatric liver transplantation  
*L.M. Nieuwenhuis<sup>1</sup>, M. van Londen<sup>2</sup>, M.J.M. Werner<sup>1</sup>, R.H.J. de Kleine<sup>1</sup>, M.T. de Boer<sup>1</sup>, F.A.J.A. Bodewes<sup>3</sup>, R.J. Porte<sup>1</sup>, V.E. de Meijer<sup>1</sup>. <sup>1</sup>Dept. of HPB Surgery and Liver Transplantation, UMC Groningen, Groningen. <sup>2</sup>Dept. of Internal Medicine, University Medical Center Groningen. <sup>3</sup>Dept. of Pediatric Gastroenterology and Hepatology, University Medical Center Groningen, Groningen, The Netherlands.*

8. Single Antigen Bead Cut-offs and their relationship with kidney graft survival  
E.G. Kamburova<sup>1</sup>, B.W. Wisse<sup>1</sup>, A. van der Meer<sup>2</sup>, I. Joosten<sup>2</sup>, W.A. Allebes<sup>2</sup>, L.B. Hilbrands<sup>3</sup>, M.C. Baas<sup>3</sup>, E. Spierings<sup>1</sup>, C.E. Hack<sup>1</sup>, F.E. van Reekum<sup>4</sup>, A.D. van Zuilen<sup>4</sup>, M.C. Verhaar<sup>4</sup>, M.L. Bots<sup>5</sup>, A.C.A.D. Drop<sup>1</sup>, L. Plaisier<sup>1</sup>, M.A.J. Seelen<sup>6</sup>, J.S.F. Sanders<sup>6</sup>, B.G. Hepkema<sup>7</sup>, A.J. Lambeck<sup>7</sup>, L.B. Bungener<sup>7</sup>, C. Roozendaal<sup>7</sup>, M.G.J. Tilanus<sup>8</sup>, C.E. Voorter<sup>8</sup>, L. Wieten<sup>8</sup>, E.M. van Duijnhoven<sup>9</sup>, M. Gelens<sup>9</sup>, M.H.L. Christiaans<sup>9</sup>, F.J. van Ittersum<sup>10</sup>, A. Nurmohamed<sup>10</sup>, N.M. Lardy<sup>11</sup>, W. Swelsen<sup>11</sup>, K.A. van der Pant<sup>12</sup>, N.C. van der Weerd<sup>12</sup>, I.J.M. ten Berge<sup>12</sup>, F.J. Bemelman<sup>12</sup>, A. Hoitsma<sup>13</sup>, P.J.M. van der Boog<sup>14</sup>, J.W. de Fijter<sup>14</sup>, M.G.H. Betjes<sup>15</sup>, S. Heidt<sup>16</sup>, D.L. Roelen<sup>16</sup>, F.H. Claas<sup>16</sup>. <sup>1</sup>Laboratory of Translational Immunology, University Medical Center Utrecht, Utrecht. <sup>2</sup>Laboratory Medicine, Lab. Medical Immunology, Radboud University Medical Center, Nijmegen. <sup>3</sup>Dept. of Nephrology, Radboud University Medical Center, Nijmegen. <sup>4</sup>Dept. of Nephrology, University Medical Center Utrecht, Utrecht. <sup>5</sup>Julius Center for Health Sciences and Primary Care, University Medical Center Utrecht, Utrecht. <sup>6</sup>Dept. of Nephrology, University of Groningen, UMC Groningen, Groningen. <sup>7</sup>Dept. of Laboratory Medicine, University of Groningen, UMC Groningen, Groningen. <sup>8</sup>Dept. of Transplantation Immunology, Tissue Typing Laboratory, Maastricht UMC, Maastricht. <sup>9</sup>Dept. of Internal Medicine, Division of Nephrology, Maastricht UMC, Maastricht. <sup>10</sup>Dept. of Nephrology, VU University Medical Center, Amsterdam. <sup>11</sup>Dept. of Immunogenetics, Sanquin, Amsterdam. <sup>12</sup>Renal Transplant Unit, Dept. of Internal Medicine, Academic Medical Center, Amsterdam. <sup>13</sup>Dutch Organ Transplant Registry (NOTR), Dutch Transplant Foundation (NTS), Leiden. <sup>14</sup>Dept. of Nephrology, Leiden University Medical Center, Leiden. <sup>15</sup>Dept. of Internal Medicine, Nephrology, Erasmus MC University Medical Center, Rotterdam. <sup>16</sup>Dept. of Immunohematology and Blood Transfusion, Leiden UMC, Leiden, The Netherlands.
9. Endogenous Glucocorticoid Metabolites and Mortality in Prednisolone-Treated Renal Transplant Recipients  
L.V. de Vries<sup>1</sup>, A.C. Timmermans<sup>1</sup>, I. Minovic<sup>1</sup>, M. van Faassen<sup>2</sup>, A.W. Gomes Neto<sup>1</sup>, D.J. Touw<sup>3</sup>, M.F.C. de Jong<sup>1</sup>, A.P. van Beek<sup>4</sup>, R.P.F. Dullaart<sup>4</sup>, G.J. Navis<sup>1</sup>, I.P. Kema<sup>2</sup>, S.J.L. Bakker<sup>1</sup>. <sup>1</sup>Dept. of Nephrology, University Medical Center Groningen, Groningen. <sup>2</sup>Dept. of Clinical Chemistry, University Medical Center Groningen, Groningen. <sup>3</sup>Dept. of Clinical Pharmacy, University Medical Center Groningen, Groningen. <sup>4</sup>Dept. of Endocrinology, University Medical Center Groningen, Groningen, The Netherlands.

Thursday, March 15<sup>th</sup>, 2018

10. Optimizing kidney preservation with machine perfusion - A comparison between warm and hypothermic machine perfusion of donor kidneys: A systematic review and meta-analysis  
Ö. Eryigit<sup>1</sup>, J. de Jonge<sup>1</sup>, M.J. Hoogduijn<sup>2</sup>, M.W.F. van den Hoogen<sup>2</sup>, R.W.F. de Bruin<sup>1</sup>, J.N.M. IJzermans<sup>1</sup>, R.C. Minnee<sup>1</sup>. <sup>1</sup>Dept. of Surgery, Erasmus Medical Center, Rotterdam. <sup>2</sup>Dept. of Nephrology and Transplantation, Erasmus MC, Rotterdam, The Netherlands.
- 15.45 Coffee break

---

**Poster session 3 - Clinical**

**Willem Burger Foyer**

---

*Moderator: to be announced*

*Language: English, presentation time 3 min., discussion 2 min.*

**15.15 - 15.45**

11. Combined low vitamin D and vitamin K status is associated with greater risk of premature mortality and transplant failure in stable kidney transplant recipients  
A.J. van Ballegooijen<sup>1</sup>, J.W.J. Beulens<sup>2</sup>, C.A. Keyzer<sup>3</sup>, G.J. Navis<sup>3</sup>, S.P. Berger<sup>3</sup>, M.H. de Borst<sup>3</sup>, M.G. Vervloet<sup>1</sup>, S.J.L. Bakker<sup>3</sup>. <sup>1</sup>Dept. of Nephrology, VU Medical Center, Amsterdam. <sup>2</sup>Epidemiology and Biostatistics, VU Medical Center, Amsterdam. <sup>3</sup>Dept. of Internal Medicine, UMCG, Groningen, The Netherlands.
12. Low Vegetable Intake is Associated with High Risk of New-Onset Diabetes After Renal Transplantation  
A.W. Gomes Neto<sup>1</sup>, M.C.J. Osté<sup>1</sup>, E. van den Berg<sup>1</sup>, R.O.B. Gans<sup>1</sup>, J.M. Geleijnse<sup>2</sup>, S.J.L. Bakker<sup>1</sup>, G.J. Navis<sup>1</sup>. <sup>1</sup>Dept. of Internal Medicine, University Medical Center Groningen, Groningen. <sup>2</sup>Division of Human Nutrition, Wageningen University & Research., Wageningen, The Netherlands.
13. Dietary Approach to Stop Hypertension (DASH) diet and risk of renal function decline and all-cause mortality in renal transplant recipients  
M.C.J. Osté<sup>1</sup>, A.W. Gomes-Neto<sup>1</sup>, E. Corpeleijn<sup>2</sup>, R.O.B. Gans<sup>1</sup>, M.H. de

Thursday, March 15<sup>th</sup>, 2018

Borst<sup>1</sup>, E. van den Berg<sup>1</sup>, S.S. Soedamah-Muthu<sup>3</sup>, D. Kromhout<sup>2</sup>, G.J. Navis<sup>1</sup>, S.J.L. Bakker<sup>1</sup>. <sup>1</sup>Dept. of Internal Medicine, University Medical Center Groningen, Groningen. <sup>2</sup>Dept. of Epidemiology, University Medical Center Groningen, Groningen. <sup>3</sup>Dept. of Medical and Clinical Psychology, CoRPS, Tilburg University, Tilburg, The Netherlands.

14. Higher Adherence to the Mediterranean diet is Associated with Lower Risk of Graft Failure in Renal Transplant Recipients  
A.W. Gomes Neto, M.C.J. Osté, C.G. Sotomayor, E. van den Berg, R.O.B. Gans, S.J.L. Bakker, G.J. Navis. Dept. of Internal Medicine, University Medical Center Groningen, Groningen, The Netherlands

15. Decreased graft survival of retransplants can largely be explained by increased HLA-immunization  
E.G. Kamburova<sup>1</sup>, B.W. Wisse<sup>1</sup>, I. Joosten<sup>2</sup>, W.A. Allebes<sup>2</sup>, A. van der Meer<sup>2</sup>, L.B. Hilbrands<sup>3</sup>, M.C. Baas<sup>3</sup>, E. Spierings<sup>1</sup>, C.E. Hack<sup>1</sup>, F.E. van Reekum<sup>4</sup>, A.D. van Zuilen<sup>4</sup>, M.C. Verhaar<sup>4</sup>, M.L. Bots<sup>5</sup>, A.C.A.D. Drop<sup>1</sup>, L. Plaisier<sup>1</sup>, M.A.J. Seelen<sup>6</sup>, J.S.F. Sanders<sup>6</sup>, B.G. Hepkema<sup>7</sup>, A.J. Lambeck<sup>7</sup>, L.B. Bungener<sup>7</sup>, C. Roozendaal<sup>7</sup>, M.G.J. Tilanus<sup>8</sup>, C.E. Voorter<sup>8</sup>, L. Wieten<sup>8</sup>, E.M. van Duijnhoven<sup>9</sup>, M. Gelens<sup>9</sup>, M.H.L. Christiaans<sup>9</sup>, F.J. van Ittersum<sup>10</sup>, A. Nurmohamed<sup>10</sup>, N.M. Lardy<sup>11</sup>, W. Swelsen<sup>11</sup>, K.A. van der Pant<sup>12</sup>, N.C. van der Weerd<sup>12</sup>, I.J.M. ten Berge<sup>12</sup>, F.J. Bemelman<sup>12</sup>, A. Hoitsma<sup>13</sup>, P.J.M. van der Boog<sup>14</sup>, J.W. de Fijter<sup>14</sup>, M.G.H. Betjes<sup>15</sup>, S. Heidt<sup>16</sup>, D.L. Roelen<sup>16</sup>, F.H. Claas<sup>16</sup>. <sup>1</sup>Laboratory of Translational Immunology, University Medical Center Utrecht, Utrecht. <sup>2</sup>Laboratory Medicine, Lab. Medical Immunology, Radboud University Medical Center, Nijmegen. <sup>3</sup>Dept. of Nephrology, Radboud University Medical Center, Nijmegen. <sup>4</sup>Dept. of Nephrology, University Medical Center Utrecht, Utrecht. <sup>5</sup>Julius Center for Health Sciences and Primary Care, University Medical Center Utrecht, Utrecht. <sup>6</sup>Dept. of Nephrology, University of Groningen, UMC Groningen, Groningen. <sup>7</sup>Dept. of Laboratory Medicine, University of Groningen, UMC Groningen, Groningen. <sup>8</sup>Dept. of Transplantation Immunology, Tissue Typing Laboratory, Maastricht UMC, Maastricht. <sup>9</sup>Dept. of Internal Medicine, Division of Nephrology, Maastricht UMC, Maastricht. <sup>10</sup>Dept. of Nephrology, VU University Medical Center, Amsterdam. <sup>11</sup>Dept. of Immunogenetics, Sanguin, Amsterdam. <sup>12</sup>Renal Transplant Unit, Dept. of Internal Medicine, Academic Medical Center, Amsterdam. <sup>13</sup>Dutch Organ Transplant Registry (NOTR), Dutch Transplant Foundation (NTS), Leiden. <sup>14</sup>Dept. of Nephrology, Leiden University Medical Center, Leiden. <sup>15</sup>Dept. of Internal Medicine, Nephrology, Erasmus MC, Rotterdam. <sup>16</sup>Dept. of Immunohematology and Blood Transfusion, Leiden UMC, Leiden, The Netherlands.

Thursday, March 15<sup>th</sup>, 2018

16. Innovations in transplant education: 3D virtual reality of live kidney donation and transplantation  
V.A.L. Huurman<sup>1</sup>, A.D. Pieterse<sup>2</sup>, F. Luk<sup>2</sup>, M.E.J. Reinders<sup>2</sup>. <sup>1</sup>Division of Transplantation, Dept. of Surgery, Leiden University Medical Center, Leiden,. <sup>2</sup>Dept. of Internal Medicine/Nephrology, Leiden University Medical Center, Leiden, The Netherlands.
- 15.45 Coffee break

---

**Poster session 4 - Basic translational research** **Willem Burger Zaal**

---

Moderator: to be announced

Language: English, presentation time 3 min., discussion 2 min.

**15.15 - 15.40**

17. Complement activation in antibody-mediated renal allograft rejection  
J.J. Karijosemito<sup>1</sup>, R.G.M. Lammerts<sup>1</sup>, M.A.J. Seelen<sup>1</sup>, M.R. Daha<sup>3</sup>, A. Diepstra<sup>2</sup>, J. van den Born<sup>1</sup>, S.P. Berger<sup>1</sup>, on behalf of the COMBAT Consortium. <sup>1</sup>Dept. of Nephrology, University Medical Center Groningen, Groningen. <sup>2</sup>Dept. of Pathology, University Medical Center Groningen, Groningen. <sup>3</sup>Dept. of Nephrology, Leiden University Medical Center, Leiden, The Netherlands.
18. High intragenic methylation of SERPINB9, a regulator of cytotoxicity, in T cells as a marker for skin cancer after kidney transplantation  
F.S. Peters, A.M.A. Peeters, J. van de Wetering, M.G.H. Betjes, C.C. Baan, K. Boer. Nephrology and Transplantation, Erasmus MC, Rotterdam, The Netherlands
19. Addition of different oxygen concentrations during long-term hypothermic machine perfusion in a clinically relevant porcine donation after circulatory death model.  
L.H. Venema<sup>1</sup>, A. Brat<sup>1</sup>, C. Moers<sup>2</sup>, R.J. Ploeg<sup>3</sup>, P. Hannaert<sup>4</sup>, T. Minor<sup>5</sup>, H.G.D. Leuvenink<sup>6</sup>. <sup>1</sup>Faculty of Medical Sciences, University Medical Center Groningen, Groningen, The Netherlands. <sup>2</sup>Organ Donation and Transplantation, University Medical Center Groningen, Groningen, The Netherlands. <sup>3</sup>Nuffield Dept. of Surgical Sciences, University of Oxford, United Kingdom, Oxford, United Kingdom. <sup>4</sup>Faculté de Médecine et de



Thursday, March 15<sup>th</sup>, 2018

Pharmacie, Université de Poitiers, France. <sup>5</sup>Dept. of Surgical Research/General Surgery, University Hospital Essen, Germany. <sup>6</sup>Dept. of Surgery, University Medical Center Groningen, Groningen, The Netherlands

20. Membrane particles generated from mesenchymal stromal cell modulate immune responses by selective targeting of proinflammatory monocytes  
A. Merino<sup>1</sup>, F. Goncalves<sup>2</sup>, F. Luk<sup>1</sup>, S.S. Korevaar<sup>1</sup>, A. Paz<sup>2</sup>, C. Lopez-Iglesias<sup>3</sup>, C. Baan<sup>1</sup>, M.J. Hoogduijn<sup>1</sup>. <sup>1</sup>Dept. of Internal Medicine, Erasmus Medical Center, Rotterdam, The Netherlands. <sup>2</sup>Experimental Research Center, Hospital de Clínicas de Porto Alegre, Porto Alegre, Brazil. <sup>3</sup>Maastricht Multimodal Molecular Imaging Institute M4I, Maastricht, The Netherlands.
21. Targeting the CD40-costimulation pathway by CFZ533 prevents the cross-talk between follicular T helper cells and B cells  
R. Kraaijeveld, C.C. Baan, M.W.F. Van den Hoogen. Dept. of Internal Medicine, Erasmus Medical Center, Rotterdam, The Netherlands.

15.45 Coffee Break

---

**Poster session 5 – Donation**

**Willem Burger Zaal**

---

Moderator: to be announced

Language: English, presentation time 3 min., discussion 2 min.

**15.15 - 15.35**

22. Chronic Inguinal Pain after Living Kidney Donation.  
M. Zorgdrager<sup>1</sup>, M. Van Londen<sup>2</sup>, L.B. Westenberg<sup>3</sup>, G.J. Nieuwenhuijs<sup>4</sup>, S.H. Hofker<sup>3</sup>, M.H. De Borst<sup>2</sup>, J.F.M. Lange<sup>3</sup>, S.J.L. Bakker<sup>2</sup>, H.G.D. Leuvenink<sup>3</sup>, R.A. Pol<sup>3</sup>. <sup>1</sup>Dept. of Radiology, University Medical Center Groningen, Groningen. <sup>2</sup>Dept. of Internal Medicine, University Medical Center Groningen, Groningen. <sup>3</sup>Dept. of Surgery, University Medical Center Groningen, Groningen. <sup>4</sup>Dept. of Anesthesiology, University Medical Center Groningen, Groningen, The Netherlands.

Thursday, March 15<sup>th</sup>, 2018

23. Additional findings with CT when assessing suitability for living kidney donation  
*M. Marcel<sup>1</sup>, R.C. Minnee<sup>2</sup>, J.I. Roodnat<sup>3</sup>, T. van den Berg<sup>2</sup>, H.G.D. Leuvenink<sup>4</sup>, R.A. Pol<sup>5</sup>. <sup>1</sup>Dept. of Radiology, University Medical Center Groningen, Groningen. <sup>2</sup>Dept. of Surgery, Erasmus Medical Center, Rotterdam. <sup>3</sup>Dept. of Nephrology, Erasmus Medical Center, Rotterdam. <sup>4</sup>Division of Transplantation, University Medical Center Groningen, Groningen. <sup>5</sup>Dept. of Surgery, University Medical Center Groningen, Groningen, The Netherlands.*
24. Na transplantatie bergen verzetten.  
*L. Bruinenberg, B.G. Hepkema, S.P. Berger. Groningen Transplantatie Centrum, Universitair Medisch Centrum Groningen, Groningen, The Netherlands.*
25. Normothermic regional perfusion in a DCD-III scenario: first experience  
*I.J. Schurink<sup>1</sup>, J. de Haan<sup>2</sup>, J. Erdmann<sup>3</sup>, V.A.L. Huurman<sup>3</sup>, J.N.M. Ijzermans<sup>4</sup>, J. de Jonge<sup>4</sup>, W.G. Polak<sup>4</sup>. <sup>1</sup>Dept. of surgery, Erasmus Medical Center, Rotterdam. <sup>2</sup>Dept. of Intensive Care Medicine, Erasmus Medical Center, Rotterdam. <sup>3</sup>Dept. of Surgery, Leiden University, Leiden. <sup>4</sup>Dept. of Surgery, Erasmus Medical Center, Rotterdam, The Netherlands.*
- 15.45 Coffee break

Thursday, March 15<sup>th</sup>, 2018

---

**Parallel session 7 - Basic/Translational research**      **Van Weelde Zaal**

---

Chairs:      *to be announced*

Language:    *English, presentation time 7 min., discussion 3 min.*

- 16.15      A novel endothelial cell based complement dependent cytotoxicity test in kidney transplantation  
*R.G.M. Lammerts, J. van den Born, W.A. Dam, M.A.J. Seelen, B.G. Hepkema, B.J. Kroesen, M.R. Daha, R.A. Pol, S.P. Berger, on behalf of the COMBAT Consortium. Dept. of Nephrology, University Medical Centre Groningen, University of Groningen, The Netherlands.*
- 16.25      Tacrolimus exposure in human proximal tubule cells results in differentially increased CTGF expression in relation to pharmacogenetic variants of CYP3A5 and ABCB1  
*N. Knops<sup>1</sup>, Y. Ramazani<sup>2</sup>, L. Van den Heuvel<sup>3</sup>, R. Goldschmeding<sup>4</sup>, T. Nguyen<sup>4</sup>, E. Levtchenko<sup>1</sup>, D. Kuypers<sup>5</sup>. <sup>1</sup>Dept. of Pediatric Nephrology, UZ Leuven, Leuven, Belgium. <sup>2</sup>Laboratory for Pediatrics, KU Leuven, Leuven, Belgium. <sup>3</sup>Laboratory for Pediatrics, UZ Leuven, Leuven, Belgium. <sup>4</sup>Dept. of Pathology, UMC Utrecht, Utrecht, The Netherlands. <sup>5</sup>Dept. of Nephrology, UZ Leuven, Leuven, Belgium*
- 16.35      High oxygen pressure during continuous hypothermic machine perfusion is associated with a better ex vivo renal blood flow and early graft function in a porcine DCD auto-transplant model  
*T. Darius<sup>1</sup>, P. Gianello<sup>2</sup>, A. Buemi<sup>1</sup>, M. De Meyer<sup>1</sup>, M. Mourad<sup>1</sup>. <sup>1</sup>Dept. Of Surgery and Abdominal Transplant Unit, University Clinics Saint Luc, Brussels. <sup>2</sup>Pôle de Chirurgie Expérimentale et Transplantation, Université catholique de Lou, Brussels, Belgium.*
- 16.45      High numbers of donor-specific il-21 producing cells predict rejection after kidney transplantation: a cross validation study  
*N.M. van Besouw<sup>1</sup>, L. Yan<sup>1</sup>, P. de Kuiper<sup>1</sup>, M. Klepper<sup>1</sup>, D. Reijerkerk<sup>1</sup>, D.L. Roelen<sup>2</sup>, F.H.J. Claas<sup>2</sup>, M.C. Clahsen-van Groningen<sup>3</sup>, D.A. Hesselink<sup>1</sup>, C.C.*

Thursday, March 15<sup>th</sup>, 2018

Baan<sup>1</sup>. <sup>1</sup>Dept. of Internal Medicine, Nephrology & Transplantation, Erasmus Medical Center, Rotterdam. <sup>2</sup>Dept. of Immunohematology and Blood Transfusion, Leiden University Medical Center, Leiden. <sup>3</sup>Dept. of Pathology, Erasmus Medical Center, Rotterdam, The Netherlands.

16.55 Tissue-resident memory T cells of donor origin are short-lived in renal allografts after transplantation

K. de Leur<sup>1</sup>, M. Dieterich<sup>1</sup>, O.B.J. Corneth<sup>2</sup>, G.N. de Graav<sup>1</sup>, A. Mulder<sup>3</sup>, F.J.M.F. Dor<sup>4</sup>, H.J.A.N. Kimenai<sup>4</sup>, F.H.J. Claas<sup>3</sup>, D.A. Hesselink<sup>1</sup>, M.C. Clahsen-van Groningen<sup>5</sup>, L.J.W. van der Laan<sup>4</sup>, R.W. Hendriks<sup>2</sup>, C.C. Baan<sup>1</sup>. <sup>1</sup>Dept. of Internal Medicine, Erasmus University Medical Center, Rotterdam. <sup>2</sup>Dept. of Pulmonary Medicine, Erasmus University Medical Center, Rotterdam. <sup>3</sup>Dept. of Immunohematology and Blood Transfusion, LUMC, Leiden. <sup>4</sup>Dept. of Surgery, Erasmus University Medical Center, Rotterdam. <sup>5</sup>Dept. of Pathology, Erasmus University Medical Center, Rotterdam, The Netherlands.

17.05 Differentiation of human induced pluripotent stem cells (ipsc) into kidney organoids for use in kidney regeneration

A.S. Shankar<sup>1</sup>, S.S. Korevaar<sup>1</sup>, M.C. Clahsen-van Groningen<sup>2</sup>, M. Ghazvini<sup>3</sup>, J. Gribnau<sup>3</sup>, C.C. Baan<sup>1</sup>, E.J. Hoorn<sup>1</sup>, M.J. Hoogduijn<sup>1</sup>. <sup>1</sup>Dept. of Internal Medicine, Erasmus Medical Center, Rotterdam. <sup>2</sup>Dept. of Pathology, Erasmus Medical Center, Rotterdam. <sup>3</sup>Dept. of Developmental Biology, Erasmus MC, Rotterdam, The Netherlands.

17.15 End of session 5

Chairs: to be announced

Language: English, presentation time 7 min., discussion 3 min.

- 16.15 Post-transplant Muscle Mass measured by Urinary Creatinine Excretion Rate predicts Long-term Outcomes after Liver Transplantation  
S.P. Stam<sup>1</sup>, M.C.J. Osté<sup>1</sup>, M.F. Eisenga<sup>1</sup>, H. Blokzijl<sup>2</sup>, A.P. van den Berg<sup>2</sup>, S.J.L. Bakker<sup>1</sup>, V.E. de Meijer<sup>3</sup>. <sup>1</sup>Dept. of Internal Medicine, University Medical Center Groningen, Groningen. <sup>2</sup>Dept. of Hepatology, University Medical Center Groning, Groningen. <sup>3</sup>Dept. of Surgery, University Medical Center Groningen, Groningen, The Netherlands
- 16.25 The clinical significance of epitope mismatch load in kidney transplantation  
L. Daniëls<sup>1</sup>, J.L. Bosmans<sup>2</sup>, D. Abramowicz<sup>2</sup>, E. Nagler<sup>3</sup>, S. Van Laecke<sup>3</sup>, P. Peeters<sup>3</sup>, D. Kuypers<sup>4</sup>, M. Naesens<sup>4</sup>, M.P. Emonds<sup>5</sup>. <sup>1</sup>Histocompatibility and Immunogenetics Laboratory (HILA), Red Cross-Flanders, Mechelen. <sup>2</sup>Dept. of Nephrology, Antwerp University Hospital, <sup>3</sup>Dept. of Nephrology, Ghent University Hospital, <sup>4</sup>Dept. of Nephrology and Renal Transplantation, University Hospitals Leuven, Leuven. <sup>5</sup>Histocompatibility and Immunogenetics Laboratory (HILA), Red-Cross Flanders, Mechelen, Belgium.
- 16.35 Risks and benefits of colonoscopy in pre-liver transplantation screening.  
R.C. Oey<sup>1</sup>, L. van Tilburg<sup>1</sup>, N.S. Erler<sup>2</sup>, H.J. Metselaar<sup>1</sup>, H.R. van Buuren<sup>1</sup>, R.A. de Man<sup>1</sup>. <sup>1</sup>Dept. Gastroenterology and Hepatology, Erasmus MC, Rotterdam. <sup>2</sup>Dept of Epidemiology, Erasmus Medical Center, Rotterdam, The Netherlands.
- 16.45 Liver transplantation in Jehovah's witnesses:  
a single center experience  
M. Vandermeulen<sup>2</sup>, N. Meurisse<sup>2</sup>, M.F. Hans<sup>2</sup>, J. Monard<sup>2</sup>, M.H. Delbouille<sup>2</sup>, P. Damas<sup>3</sup>, A. Kaba<sup>3</sup>, J. Joris<sup>3</sup>, P. Honore<sup>2</sup>, O. Detry<sup>1</sup>. <sup>1</sup>Dept. of transplantation, CHU Liege, Liège. <sup>2</sup>Dept. of Surgery & Transplantation, CHU Liege, Liege. <sup>3</sup>Dept. of Anesthesiology and Intensive Care, CHU Liege, Liege, Belgium.

Thursday, March 15<sup>th</sup>, 2018

- 16.55 New population pharmacokinetic model that predicts the individual starting dose of tacrolimus following pediatric renal transplantation  
*L.M. Andrews<sup>1</sup>, D.A. Hesselink<sup>2</sup>, T. van Gelder<sup>2</sup>, E.A. Cornelissen<sup>3</sup>, S.N. de Wildt<sup>4</sup>, B.C.P. Koch<sup>1</sup>, K. Cransberg<sup>5</sup>, B.C.M. de Winter<sup>1</sup>. <sup>1</sup>Dept. of Hospital Pharmacy, Erasmus Medical Center, Rotterdam. <sup>2</sup>Dept. of Internal Medicine, Erasmus Medical Center, Rotterdam. <sup>3</sup>Dept. of Pediatric Nephrology, Radboudumc Amalia Children's Hospital, Nijmegen. <sup>4</sup>Dept. of Pharmacology and Toxicology, Radboud University, Nijmegen. <sup>5</sup>Dept. of Pediatric Nephrology, Erasmus MC-Sophia Children's Hospital, Rotterdam, The Netherlands.*
- 17.05 Gut Microbiome in Kidney Transplant Recipients  
*J.C. Swarte<sup>1</sup>, H.J.M. Harmsen<sup>2</sup>, S.J.L. Bakker<sup>1</sup>. <sup>1</sup>Dept. of Internal Medicine and Nephrology, University Medical Center of Groningen, Groningen. <sup>2</sup>Dept. of Microbiology, Infectious Disease, University Medical Center Groningen, Groningen, The Netherlands.*
- 17.15 End of session 8

---

**Parallel session 9 - Nursing**

**Van der Vorm/Plate Zaal**

---

*Chairs: to be announced*

*Language: Nederlands, spreektijd 8 min., discussietijd 2 min.*

- 16.15 Naar een eenduidige psychosociale screening van longtransplantatiepatiënten.  
*S.H. Smit, T. Norder. Dept. of Lung Diseases and Tuberculosis, University Medical Center Groningen, Groningen, The Netherlands*
- 16.25 Evaluatie en ervaringen voorlichting niertransplantatie nieuwe stijl: 'U vraagt, wij draaien'  
*S. Middel, C.A.J. Oudmaijer, I. de Koning, L. Wiekamp, W. van der Bent, J. van de Wetering. Dept. of Internal Medicine, Erasmus Medical Center, Rotterdam, The Netherlands.*

Thursday, March 15<sup>th</sup>, 2018

- 16.35 Introduction of routine monitoring of smoking resumption after lung transplantation  
R.A.S. Hoek<sup>1</sup>, J. den Ouden<sup>1</sup>, L. Seghers<sup>1</sup>, E. Mahtab<sup>2</sup>, J.A. Bekkers<sup>2</sup>, H.C. Hoogsteden<sup>1</sup>, M.E. Hellemons<sup>1</sup>. <sup>1</sup>Dept. of Pulmonary Medicine, Erasmus MC, Rotterdam, Rotterdam. <sup>2</sup>Dept. of Cardiothoracic Surgery, Erasmus MC, Rotterdam, The Netherlands.
- 16.45 valuating the effects of a nurse-led self-management intervention for kidney transplant patients: mixed-method design  
J.M.J. Been-Dahmen<sup>1</sup>, D. Beck<sup>2</sup>, M.A.C. Peeters<sup>1</sup>, H. van der Stege<sup>1</sup>, J. Grijpma<sup>2</sup>, M. Tielen<sup>2</sup>, M. van Buren<sup>2</sup>, W. Weimar<sup>2</sup>, E. Ista<sup>3</sup>, A. van Staa<sup>1</sup>, E. Massey<sup>2</sup>. <sup>1</sup>Research Center Innovations in Care, Rotterdam University of Applied Science, Rotterdam. <sup>2</sup>Dept. of Internal Medicine, Erasmus Medical Center, Rotterdam. <sup>3</sup>Dept. of Intensive care, Erasmus Medical Center-sophia children's hospital, Rotterdam, The Netherlands.
- 16.55 psychosociaal screenen van kandidaten voor niertransplantatie.  
M.J.M. van Helden, P.A.J. Weide, G. van den Bosch, L.B. Hilbrands. Dept. of Nephrology, Radboudumc, Nijmegen, The Netherlands.
- 17.05 Current nursing insights on forearm to trachea transplantation.  
M. Schoonis. Dept. of Pneumology, University Hospital Leuven, Leuven, Belgium.
- 17.15 End session 9

Thursday, March 15<sup>th</sup>, 2018

---

**Parallel session 10 - Transplant Coordination**      **Van Rijck/Ruys Zaal**

---

Chairs:      to be announced

Language:    English, presentation time 7 min., discussion 3 min.

- 16.15      A multidisciplinary approach on the emergency Dept. to admit potential organ donors for end-of-life care to the intensive care unit  
M. Witjes<sup>1</sup>, A. Kotsopoulos<sup>2</sup>, L. Otterspoor<sup>3</sup>, I.H.F. Herold<sup>4</sup>, K.S. Simons<sup>5</sup>, K. Woittiez<sup>6</sup>, J.J.A. Eijkenboom<sup>7</sup>, J.G. van der Hoeven<sup>8</sup>, W.F. Abdo<sup>8</sup>. <sup>1</sup>Intensive Care, Nijmegen. <sup>2</sup>Care, Elisabeth Tweesteden hospital, Tilburg. <sup>3</sup>Dept. of Intensive Care, Catharina hospital, Eindhoven. <sup>4</sup>Dept. of Intensive Care, Catharina hospital, Eindhoven. <sup>5</sup>Dept. of Intensive Care, Jeroen Bosch hospital, 's-hertogenbosch. <sup>6</sup>Dept. of Intensive Care, VieCuri hospital, Venlo. <sup>7</sup>Dept. of Intensive Care, Maxima medical center, Veldhoven. <sup>8</sup>Dept. of Intensive Care, Radboudumc, Nijmegen, The Netherlands
- 16.25      What lessons can be learned from the UK experience of (relinquishing) anonymity?  
E.K. Massey<sup>1</sup>, M.C. Pronk<sup>1</sup>, D. Slaats<sup>1</sup>, L. Burnapp<sup>2</sup>. <sup>1</sup>Erasmus MC, Internal Medicine, Rotterdam, The Netherlands. <sup>2</sup>NHS Blood & Transplant, London, United Kingdom.
- 16.35      Pre-donation recruitment of Renal functional Reserve is associated with early renal adaptation after living kidney donation.  
N.R. Hessels, M. van Londen, N. Kasper, A.L. Messchendorp, J. van der Weijden, J.S.F. Sanders, S.P. Berger, S.J.L. Bakker, M.H. de Borst, G. Navis. Dept. of Internal Medicine, University Medical Center Groningen, Groningen, The Netherlands
- 16.45      Additional value of smartphone video recordings for the assessment of organ quality for livertransplantation.  
J.I. Erdmann<sup>1</sup>, W.N. Nijboer<sup>1</sup>, M.T. de Boer<sup>3</sup>, W.G. Polak<sup>4</sup>. <sup>1</sup>Dept. of Surgery, LUMC, Leiden. <sup>3</sup>Dept. of Surgery, UMCG, Groningen. <sup>4</sup>Dept. of Surgery, Erasmus MC, Rotterdam, The Netherlands.



Thursday, March 15<sup>th</sup>, 2018

16.55 Estimated GFR at Donor Screening to Predict mGFR after Living Kidney Donation.

*J. van der Weijden, M. van Londen, S.J.L. Bakker, S.P. Berger, G.J. Navis, M.H. de Borst. Dept. of Internal Medicine, University Medical Center Groningen, Groningen, The Netherlands.*

17.05 Donor Knowledge of Provided Information - A Prospective Nationwide Inventory Study

*K. Kortram<sup>1</sup>, E.Q.W. Spoon<sup>1</sup>, S.Y. Ismail<sup>2</sup>, D. Nieboer<sup>3</sup>, F.C.H. D'Ancona<sup>4</sup>, M.H.L. Christiaans<sup>5</sup>, R.E. Dam<sup>6</sup>, H.S. Hofker<sup>7</sup>, A.W.J. Hoskbergen<sup>8</sup>, K.A.M.I. Van der Pant<sup>9</sup>, R.J. Toorop<sup>10</sup>, J. Van de Wetering<sup>11</sup>, J.N.M. IJzermans<sup>1</sup>, F.J.M.F. Dor<sup>1</sup>. <sup>1</sup>Dept. of Surgery, Erasmus Medical Center, Rotterdam. <sup>2</sup>Dept. of Psychiatry, Erasmus Medical Center, Rotterdam. <sup>3</sup>Dept. of Public Health, Erasmus Medical Center, Rotterdam. <sup>4</sup>Dept. of Urology, Radboud University Medical Center, Nijmegen. <sup>5</sup>Dept. of Nephrology, Maastricht University Medical Center, Maastricht. <sup>6</sup>Dept. of Surgery, Leiden University Medical Center, Leiden. <sup>7</sup>Dept. of Surgery, University Medical Center Groningen, Groningen. <sup>8</sup>Dept. of Surgery, VU Medical Center, Amsterdam. <sup>9</sup>Dept. of Nephrology, Academic Medical Center, Amsterdam. <sup>10</sup>Dept. of Surgery, University Medical Center Utrecht, Utrecht. <sup>11</sup>Dept. of Nephrology, Erasmus Medical Center, Rotterdam, The Netherlands.*

Thursday, March 15<sup>th</sup>, 2018

---

**Assembly NTV**

**Willem Burger Zaal**

---



NEDERLANDSE **TRANSPLANTATIE** VERENIGING

- 17.30 Assembly Nederlandse Transplantatie Vereniging
- 19.00 Transfer to the ss Rotterdam
- 20.00 Social evening on board of the ss Rotterdam

---

**Assembly BTS**

**Van Weelde Zaal**

---



- 17.30 Assembly Belgium Transplantation Society
- 19.00 Transfer to the ss Rotterdam
- 20.00 Social evening on board of the ss Rotterdam

Friday, march 16<sup>th</sup>, 2018

---

**Plenary session II**

**Willem Burger Zaal**

---

Chairs: to be announced

**Topic: Crossing borders in basic & translational science**

Language: English

09.00 The Emerging Role of DNA Methylation in Kidney Transplantation:  
A Perspective

*Dr. Line Heylen, KUL, Leuven, Belgium*

09.20 Implementation of miRNAs as predictors of rejection into daily  
practice

*Prof. dr. Abraham Shaked (Philadelphia, USA)*

09.40 iBOX a next step to predicting long-term allograft failure

*Prof. dr. Alexander Loupy (Paris, France)*

10.00 Coffee break and moderated poster session II

---

**Poster session 6 – Clinical**

**Willem Burger Foyer**

---

Moderator: to be announced

Language: English, presentation time 3 min., discussion 2 min.

**10.00 – 10.30**

26. Safety and efficacy of third kidney transplantation in ipsilateral iliac  
fossa

*P.J. Domagala<sup>1</sup>, T. van den Berg<sup>2</sup>, K. Tran<sup>1</sup>, T. Terkivatan<sup>1</sup>, H. Kimenai<sup>1</sup>, J. IJzermans<sup>1</sup>, R. Pol<sup>2</sup>, R. Minnee<sup>1</sup>. <sup>1</sup>Dept. of Surgery, Division of HPB & Transplant Surgery, Erasmus MC, Rotterdam. <sup>2</sup>Dept. of Surgery and Transplantation, University of Medical Center Groningen, Groningen, The Netherlands.*

Friday, march 16<sup>th</sup>, 2018

27. SLC30A8 polymorphism and BMI complement HLA-A\*24 as risk factors for poor graft function in islet allograft recipients  
*E.M. Balke<sup>1</sup>, S. Demeester<sup>1</sup>, D. Lee<sup>1</sup>, P. Gillard<sup>1</sup>, R. Hilbrands<sup>1</sup>, U. van de Velde<sup>1</sup>, B.J. van der Auwera<sup>1</sup>, Z. Ling<sup>1</sup>, B.O. Roep<sup>2</sup>, D.G. Pipeleers<sup>1</sup>, B. Keymeulen<sup>1</sup>, F.K. Gorus<sup>1</sup>. <sup>1</sup>Diabetes Research Center, Vrije Universiteit Brussel, Brussel, Belgium. <sup>2</sup>Dept. of Immunohaematology and Blood Transfusion, Leiden University Medica, Leiden, The Netherlands.*
28. How safe is crossing the ABO blood group barrier? A meta-analysis to determine the additive risk of ABO-incompatible kidney transplantation.  
*A.E. de Weerd, M.G.H. Betjes. Dept. of Internal Medicine, Erasmus Medical Center, Rotterdam, The Netherlands.*
29. A predictive pharmacokinetic model of ribavirin plasma concentration in lung transplant recipients treated for a paramyxovirus or chronic Hepatitis E virus infection.  
*A.E.S. de Zwart<sup>1</sup>, E. eliza Milliken<sup>2</sup>, S. Reuter lange<sup>3</sup>, A. Riezebos-Brilman<sup>4</sup>, F. Burrows<sup>2</sup>, J.W.C. Alffenaar<sup>5</sup>, A. Glanville<sup>6</sup>, E.A.M. Verschuuren<sup>7</sup>. <sup>1</sup>Dept. of Pulmonary diseases and tuberculosis, University Medical center Groningen, Groningen, The Netherlands. <sup>2</sup>Faculty of Medicine , The University of Notre Dame, Sydney , Australia,; Sydney, Australia. <sup>3</sup>St Vincent's Hospital , Sydney, Australia,; Sydney, Australia. <sup>4</sup>Dep of Medical microbiology, University Medical center Utrecht, Utrecht, The Netherlands. <sup>5</sup>Dept. of clinical pharmacy and Pharmacology, University Medical Center Groningen, Groningen, The Netherlands. <sup>6</sup>Faculty of Medicine , The University of Notre Dame, Sydney , Australia, Sydney, Australia. <sup>7</sup>Dept. of Pulmonary Diseases and tuberculosis, University Medical Center Groningen, Groningen, The Netherlands.*
30. Pre-Transplant Duration of Dialysis, N-terminal Pro-Brain Natriuretic Peptide and Post-Transplant Mortality in Renal Transplant Recipients  
*M.H. Yeung<sup>1</sup>, M. van Londen<sup>1</sup>, U. Nakshbandi<sup>1</sup>, Y.M. Said<sup>1</sup>, M.F. Eisenga<sup>1</sup>, B. Hepkema<sup>2</sup>, I.M. Nolte<sup>3</sup>, S.P. Berger<sup>1</sup>, M.H. de Borst<sup>1</sup>, S.J.L. Bakker<sup>1</sup>. <sup>1</sup>Dept. of Internal Medicine, div of Nephrology, Uni. Medical Center Groningen, Groningen. <sup>2</sup>Transplantation Immunology EA51, UMCG, Groningen. <sup>3</sup>Dept. of Epidemiology, University Medical Center Groningen, Groningen, The Netherlands.*

Friday, march 16<sup>th</sup>, 2018

31. Urinary Excretion of the Main Metabolite of Melatonin Relates to All-Cause and Cardiovascular Mortality in Renal Transplant Recipients  
A. van der Veen<sup>1</sup>, I. Minovic<sup>2</sup>, H.J.R. van Faassen<sup>1</sup>, I.P. Kema<sup>1</sup>, S.J.L. Bakker<sup>2</sup>.  
<sup>1</sup>Dept. of Laboratory Medicine, University Medical Center Groningen, Groningen. <sup>2</sup>Dept. of Nephrology, University Medical Center Groningen, Groningen, The Netherlands.

---

**Poster session 7 - Clinical**

**Willem Burger Foyer**

---

Moderator: to be announced

Language: English, presentation time 3 min., discussion 2 min.

**10.00 – 10.30**

32. sCD59 as a novel biomarker for acute rejection in kidney transplantation  
L.A. Michielsen<sup>1</sup>, A.D. Van Zuilen<sup>1</sup>, T. Kardol-Hoefnagel<sup>2</sup>, M.C. Verhaar<sup>1</sup>, H.G. Otten<sup>2</sup>. <sup>1</sup>Dept. of Nephrology and Hypertension, UMC Utrecht, Utrecht. <sup>2</sup>Laboratory of Translational Immunology, University Medical Center Utrecht, Utrecht, The Netherlands
33. Computerised Integration of Alternative kidney Transplantation (CIAT) programs: a simulation  
M. de Klerk<sup>1</sup>, J.A. Kal<sup>1</sup>, S. Middel<sup>1</sup>, J. van de Wetering<sup>1</sup>, M.M.L. Kho<sup>1</sup>, M.G.H. Betjes<sup>1</sup>, W.C. Zuidema<sup>1</sup>, D.L. Roelen<sup>2</sup>, K.M. Glorie<sup>3</sup>, J.I. Roodnat<sup>1</sup>.  
<sup>1</sup>Dept. of Internal Medicine, Erasmus Medical Center, Rotterdam. <sup>2</sup>Dept. of Immunohematology, LUMC, Leiden. <sup>3</sup>Erasmus Q-Intelligence, Erasmus University, Rotterdam, The Netherlands.
34. IGL-I preservation solution and liver graft function, a retrospective study  
N. Gilbo<sup>1</sup>, J. Achtergale<sup>2</sup>, J. Van den Eynde<sup>2</sup>, I. Jochmans<sup>1</sup>, M. Sainz-Barriga<sup>1</sup>, D. Monbaliu<sup>1</sup>, J. Pirenne<sup>1</sup>. <sup>1</sup>Abdominal Transplantation Surgery - University Hospitals of Leuven, Leuven. <sup>2</sup>Abdominal Transplantation Research Lab - KU Leuven, Leuven, Belgium.

Friday, march 16<sup>th</sup>, 2018

35. Peritubular capillary loss in the first month after kidney transplantation is more pronounced in patients with rejection compared to delayed graft function.  
A.A. Keijbeck<sup>1</sup>, F.M.E.G. Steegh<sup>1</sup>, M.A.C.J. Gelens<sup>2</sup>, L.W.E. van Heurn<sup>3</sup>, M.H.L. Christiaans<sup>2</sup>, C.J. Peutz-Kootstra<sup>1</sup>. <sup>1</sup>Dept. of Pathology, Maastricht University Medical Center, Maastricht. <sup>2</sup>Dept. of Internal Medicine, Maastricht University Medical Center, Maastricht, The Netherlands <sup>3</sup>Dept. of Surgery, Academic Medical Center, Amsterdam, The Netherlands
36. Relevance of EBV load monitoring in renal transplant recipients; a retrospective cohort study  
L. Gard<sup>1</sup>, C. Oliveira dos Santos<sup>1</sup>, W. Van Doesum<sup>2</sup>, H.G.M. Niesters<sup>1</sup>, W.J. Van Son<sup>2</sup>, A. Diepstra<sup>3</sup>, C.A. Stegeman<sup>2</sup>, H. Groen<sup>4</sup>, J.S. Sanders<sup>2</sup>, A. Riezebos-Brilman<sup>5</sup>. <sup>1</sup>Dept. of Medical Microbiology, University Medical Center Groningen, Groningen. <sup>2</sup>Dept. of Internal Medicine, University Medical Center Groningen, Groningen. <sup>3</sup>Dept. of Pathology, University Medical Center Groningen, Groningen. <sup>4</sup>Dept. of Epidemiology, University Medical Center Groningen, Groningen. <sup>5</sup>Dept. of Medical Microbiology, University Medical Center Utrecht, Utrecht, The Netherlands.
37. Pre-operative serum potassium as a risk factor for early complications after renal transplantation: a cohort study  
B.C.S. de Vries, S.P. Berger, S.J.L. Bakker, M.H. Borst, M.F.C. de Jong. Dept. of Nephrology, Universitair Medisch Centrum Groningen, Groningen, The Netherlands.

---

**Poster session 8 - Basic translational research      Willem Burger Foyer**

---

Moderator: to be announced

Language: English, presentation time 3 min., discussion 2 min.

**10.00 – 10.30**

38. Impact of rapamycin and tacrolimus on the differentiation and maturation of monocyte-derived dendritic cells and their interactions with T cells  
G.D. Dahlqvist<sup>1</sup>, F.C. Conti<sup>2</sup>, Y.H. Horsmans<sup>3</sup>. <sup>1</sup>Dept. of Hepato-gastroenterology, Cliniques Universitaires Saint-Luc, Brussels, Belgium. Dept. of

Friday, march 16<sup>th</sup>, 2018

<sup>2</sup>Hepatologie, Hôpital de la Pitié Salpêtrière, Paris, France. <sup>3</sup>Dept. of Internal Medicine, Cliniques Universitaires Saint-Luc, Brussels, Belgium.

39. GM-CSF strongly enhances TLR9-induced phagocytic capacity and activation of human plasmacytoid dendritic cells  
*J.M. Ruben<sup>1</sup>, G. Garcia-Romo<sup>1</sup>, E. Breman<sup>1</sup>, S. van der Kooij<sup>1</sup>, A. Redeker<sup>2</sup>, R. Arens<sup>2</sup>, C. van Kooten<sup>1</sup>. <sup>1</sup>Dept. of Nephrology, Leiden University Medical Center, Leiden. <sup>2</sup>Dept. of Immunohematology and Blood Transfusion, Leiden University Medical, Leiden, The Netherlands.*
40. Targeted elimination of senescent cells to protect kidneys against ischemia reperfusion injury  
*H. van Willigenburg<sup>1,2</sup>, R.W.F. de Bruin<sup>1</sup>, P.L.J. de Keizer<sup>2</sup>. <sup>1</sup>Dept. of Surgery, Erasmus Medical Center, Rotterdam. <sup>2</sup>Dept. of Molecular Genetics, Rotterdam, The Netherlands.*
41. HLA-B\*15 allele SNPs predict the serologically defined HLA-B15 split antigens  
*B. Duygu, B.M. Matern, C.M.H. Meertens, C.E.M. Voorter, M.G.J. Tilanus. Dept. of Transplantation Immunology, Maastricht University Medical Center, Maastricht, The Netherlands.*
42. Single-cell Analysis of NFATc1 Amplification in T Cells for Pharmacodynamic Monitoring of Tacrolimus  
*N.M. Kannegieter, D.A. Hesselink, M. Dieterich, G.N. De Graav, R. Kraaijeveld, C.C. Baan. Dept. of Internal Medicine, Erasmus Medical Center, Rotterdam, The Netherlands.*
43. Normothermic machine perfusion of ischaemically damaged porcine kidneys with autologous, allogeneic and human red blood cells  
*M.B.F. Pool, L. Hartveld, H.G.D. Leuvenink, C. Moers. Dept. of Surgery, Organ Donation & Transplantation, University Medical Center Groningen, Groningen, The Netherlands.*
- 10.30 Coffee break

Moderator: to be announced

Language: English, presentation time 3 min., discussion 2 min.

**10.00 – 10.25**

44. What is the risk of cancer transmission with heart transplantation?  
L. Stiennon<sup>1</sup>, V. Tchana-Sato<sup>2</sup>, V. Dorio<sup>3</sup>, A. Ancion<sup>3</sup>, J.O. Defraigne<sup>2</sup>, O. Detry<sup>1</sup>. <sup>1</sup>Dept. of Transplantation, CHU Liege, Liège. <sup>2</sup>Dept. of Cardiovascular Surgery, CHU Liege, Liege. <sup>3</sup>Dept. of Cardiology, CHU Liege, Liege, Belgium.
45. Comparison of Kidney Exchange Programs in Europe (COST-ENCKEP)  
B.J.J.M. Haase-Kromwijk<sup>1</sup>, A.C. Hemke<sup>1</sup>, J. van de Klundert<sup>2</sup>. <sup>1</sup>Dutch Transplant Foundation, Leiden. <sup>2</sup>Erasmus School of Health Policy & Management, Rotterdam, The Netherlands.
46. eHealth psychosocial care for living kidney donors: an implementation study  
L. Wirken<sup>1</sup>, H. van Middendorp<sup>1</sup>, C.W. Hooghof<sup>2</sup>, L.B. Hilbrands<sup>2</sup>, A.W.M. Evers<sup>1</sup>. <sup>1</sup>Health, Medical and Neuropsychology Unit, Leiden University, Leiden. <sup>2</sup>Dept. of Nephrology, Radboudumc Nijmegen, Nijmegen, The Netherlands.
47. Serious Adverse Events or Reactions in organ transplantation; raising awareness in the Netherlands  
K.G. Sparidaens<sup>1</sup>, P.R.J. de Rooij<sup>2</sup>. <sup>1</sup>Beleids- & Orgaancentrum, Dutch Transplant Foundation, Leiden. <sup>2</sup>Bedrijfsvoering, Dutch Transplant Foundation, Leiden, The Netherlands.
48. Needs for a paediatric organ and tissue donation protocol; an overview of the literature  
A. Vileito<sup>1</sup>, M.J. Siebelink<sup>2</sup>, A.A.E. Verhagen<sup>1</sup>. <sup>1</sup>Dept. of Pediatrics, Beatrix Children's Hospital, University Medical Center, Groningen. <sup>2</sup>University Medical Center Groningen Transplant Center, University Medical Center, Groningen, The Netherlands.



Friday, march 16<sup>th</sup>, 2018

---

**Parallel session 12 - Basic/Translational research**      **Van Weelde Zaal**

---

Chairs:      to be announced

Language:    English, presentation time 7 min., discussion 3 min.

- 10.30      Assessing kidney and liver viability during machine perfusion  
*I.J. Jochmans<sup>1</sup>. <sup>1</sup>Dept. of Microbiology and Immunology, KU Leuven, Leuven.*
- 10.50      Donor-derived cell-free DNA as minimally invasive tool to diagnose acute rejection after kidney transplantation  
*K. Boer<sup>1</sup>, C.C. Baan<sup>1</sup>, N. van Donk<sup>2</sup>, E. de Jonge<sup>2</sup>, M.C. Clahsen-van Groningen<sup>3</sup>, D.A. Hesselink<sup>1</sup>, R.H.N. van Schaik<sup>2</sup>. <sup>1</sup>Dept. of Internal Medicine - Nephrology and Transplantation, Erasmus Medical Center, Rotterdam. <sup>2</sup>Dept. of Clinical Chemistry, Erasmus Medical Center, Rotterdam. <sup>3</sup>Dept. of Pathology, Erasmus Medical Center, Rotterdam, The Netherlands.*
- 11.00      Mesenchymal stromal cells infused via the renal artery are retained and survive in ischemic porcine kidney  
*J.M. Sierra Parraga<sup>1</sup>, M. Eijken<sup>2</sup>, C. Andersen<sup>2</sup>, C. Moers<sup>3</sup>, R. Ploeg<sup>4</sup>, B. Møller<sup>5</sup>, C.C. Baan<sup>1</sup>, M.J. Hoogduijn<sup>1</sup>, B. Jespersen<sup>6</sup>. <sup>1</sup>Dept. of Internal Medicine, Erasmus Medical Center, Rotterdam, The Netherlands. <sup>2</sup>Institute of Clinical Medicine, Aarhus University, Aarhus, Denmark. <sup>3</sup>Organ Donation and Transplantation, University Medical Center Groningen, Groningen, The Netherlands. <sup>4</sup>Nuffield Dept. Surgical Sciences Biomedical Research Center, University of Oxford, Oxford, United Kingdom. <sup>5</sup>Dept. of Clinical Immunology, Aarhus University Hospital, Aarhus, Denmark. <sup>6</sup>Dept. of Renal Medicine, Aarhus University Hospital, Aarhus, Denmark.*
- 11.10      Autophagy in renal ischemia-reperfusion injury: effect of ischemic duration and modulation with trehalose  
*J.P.D. Decuyper<sup>1</sup>, T.W. Wylin<sup>1</sup>, V.H. Heedfeld<sup>1</sup>, D.M. Monbaliu<sup>1</sup>, W.M. Martinet<sup>2</sup>, J.P. Pirenne<sup>1</sup>, I.J. Jochmans<sup>1</sup>. <sup>1</sup>Dept. of Microbiology and Immunology, KU Leuven, Leuven. <sup>2</sup>Dept. of Pharmaceutical Sciences, University of Antwerp, Antwerp, Belgium.*

Friday, march 16<sup>th</sup>, 2018

- 11.20 Hibernating mitochondria as organ preservation: hibernator versus non-hibernator kidney mitochondria  
*K.D.W. Hendriks, R.H. Henning. Dept. of Clinical Pharmacy and Pharmacology, UMCG, Groningen, The Netherlands.*
- 11.30 Cell-free microRNAs in kidney graft preservation fluid as novel biomarker for delayed graft function.  
*H.P. Roest<sup>1</sup>, L.S.S. Ooms<sup>1</sup>, A.J.M. Gillis<sup>2</sup>, J.N.M. Ijzermans<sup>1</sup>, L.H.J. Looijenga<sup>2</sup>, F.J.M.F. Dor<sup>1</sup>, L.J.W. Van der Laan<sup>1</sup>. <sup>1</sup>Dept. of Surgery, Erasmus Medical Center, Rotterdam. <sup>2</sup>Dept. of Pathology, Erasmus Medical Center, Rotterdam, The Netherlands.*
- 11.40 Genetic inactivation of DUSP3/VHR attenuates kidney damage and inflammation following ischemia/reperfusion in mouse  
*P. Rowart<sup>1</sup>, L. Poma<sup>1</sup>, S. Rahmouni<sup>1</sup>, J.M. Krzesinski<sup>2</sup>, F. Jouret<sup>2</sup>. <sup>1</sup>University of Liège, Liège. <sup>2</sup>CHU de liège, Liège, Belgium.*
- 11.50 A novel tool to define the immunogenicity of HLA mismatches  
*C.S.M. Kramer, J. Koster, G.W. Haasnoot, D.L. Roelen, F.H.J. Claas, S. Heidt. Dept. of Immunohematology and Blood Transfusion, Leiden University Medical Center, Leiden, The Netherlands.*
- 12.00 Lunch break

---

**Parallel session 13 - Clinical**

**Willem Burger Zaal**

---

*Chairs: to be announced*

*Language: English, presentation time 7 min., discussion 3 min.*

- 10.30 Pregnancy after thoracic organ transplantation: the Belgian experience.  
*V.A.N. Cleemput<sup>1</sup>, O.V.C. Van Caenegem<sup>2</sup>, A. Roussoulières<sup>3</sup>, C. Knoop<sup>4</sup>, R. Vos<sup>5</sup>, P. Evrard<sup>6</sup>, A. Vorlat<sup>7</sup>, A. Ancion<sup>8</sup>, S. Verstreken<sup>9</sup>, V. Verplancke<sup>10</sup>, M. De Pauw<sup>11</sup>. <sup>1</sup>Dept. of Cardiology, UZ Leuven, Leuven <sup>2</sup>Heart Transplant Unit, Cliniques Universitaires Saint-Luc, Brussels. <sup>3</sup>Dept. of Cardiology, ULB, Brussels. <sup>4</sup>Dept. of Pneumology, ULB, Brussels. <sup>5</sup>Dept. of Pneumology, UZ Leuven, Leuven. <sup>6</sup>Dept. of Pneumology, CHU Godinne, Namur. <sup>7</sup>Dept. of*

Friday, march 16<sup>th</sup>, 2018

Cardiology, UZA, Antwerpen. <sup>8</sup>Dept. of Cardiology, CHU ULG, Liège. <sup>9</sup>Dept. of Cardiology, Hartcentrum OLV, Aalst. <sup>10</sup>Dept. of Pneumology, UZA, Antwerpen. <sup>11</sup>Dept. of Cardiology, UZ Gent, Gent, Belgium.

- 10.40 The effect of perioperative antiplatelet / anticoagulant therapy on the incidence of early postoperative thromboembolic complications and bleeding in kidney transplantation. - A dual center retrospective cohort study of 2000 kidney transplant recipients.  
T.A.J. van den Berg<sup>1</sup>, R.C. Minnee<sup>2</sup>, G.J. Nieuwenhuijs-Moeke<sup>3</sup>, S.J.L. Bakker<sup>4</sup>, R.A. Pol<sup>1</sup>. <sup>1</sup>Dept. of Surgery, University Medical Center Groningen, Groningen. <sup>2</sup>Dept. of Surgery, Erasmus Medical Center, Rotterdam. <sup>3</sup>Dept. of Anesthesiology, University Medical Center Groningen, Groningen. <sup>4</sup>Dept. of Internal Medicine - Nephrology, University Medical Center Groningen, Groningen, The Netherlands.
- 10.50 Biliary pH, Bicarbonate and Glucose are Suitable Biomarkers of Bile Duct Viability During Normothermic Machine Perfusion of Donor Livers  
A.P.M.M. Matton<sup>1</sup>, Y.D.V. de Vries<sup>1</sup>, L.C.B. Burlage<sup>1</sup>, R.V.R. van Rijn<sup>1</sup>, A.S.H.G. Gouw<sup>2</sup>, V.E.D.M. de Meijer<sup>1</sup>, T.L. Lisman<sup>3</sup>, R.J.P. Porte<sup>1</sup>. <sup>1</sup>Dept. of Surgery, University Medical Center Groningen, Groningen. <sup>2</sup>Dept. of Pathology, University Medical Center Groningen, Groningen. <sup>3</sup>Surgical Research Laboratory, University Medical Center Groningen, Groningen, The Netherlands.
- 11.00 Excellent one year graft and patient survival with comparable rejection and infection rates in ABO-incompatible kidney transplants with alemtuzumab induction compared to ABO-compatible recipients with basiliximab induction  
H. Bouwsma, E.E. Nijgh, R.E. Dam, A.T.M. Bisschop - van Leijden, M.J.K. Mallat, M.E.J. Reinders, J.W. De Fijter, A.P.J. De Vries. Transplantation Center, Leiden University Medical Center, Leiden, The Netherlands
- 11.10 Livers from donation after circulatory death donors can be safely used for retransplantation  
O.B. van Leeuwen<sup>1</sup>, M. van Reeve<sup>2</sup>, J.I. Erdmann<sup>3</sup>, H.J. Metselaar<sup>4</sup>, A.P. van den Berg<sup>5</sup>, W.G. Polak<sup>2</sup>, B. van Hoek<sup>6</sup>, R.J. Porte<sup>1</sup>. <sup>1</sup>Dept. of Surgery, University Medical Center Groningen, Groningen. <sup>2</sup>Dept. of Surgery, Erasmus Medical Center, Rotterdam. <sup>3</sup>Dept. of Surgery, Leiden University Medical Center, Leiden. <sup>4</sup>Dept. of Gastro-Enterology and Hepatology,

Friday, march 16<sup>th</sup>, 2018

Erasmus Medical Center, Rotterdam. <sup>5</sup>Dept. of Gastro-enterology and Hepatology, University Medical Center Groningen, Groningen. <sup>6</sup>Dept. of Gastro-enterology and Hepatology, Leiden University Medical Center, Leiden, The Netherlands

11.20 Lung Transplantation from ICU does not affect long-term patient and allograft survival

R.A.S. Hoek<sup>1</sup>, L. Seghers<sup>1</sup>, E. Mahtab<sup>2</sup>, J.A. Bekkers<sup>2</sup>, R.J. van Thiel<sup>3</sup>, D. Dos Reis Miranda<sup>3</sup>, H.C. Hoogsteden<sup>1</sup>, M.E. Hellemons<sup>1</sup>. <sup>1</sup>Dept. of Pulmonary Medicine, Erasmus MC, Rotterdam. <sup>2</sup>Dept. of Cardiothoracic Surgery, Erasmus MC, Rotterdam. <sup>3</sup>Dept. of Intensive Care, Erasmus MC, Rotterdam, The Netherlands.

11.30 Single lung transplantation remains a viable treatment option in selected patients

R.A.S. Hoek<sup>1</sup>, L. Seghers<sup>1</sup>, E. Mahtab<sup>2</sup>, J.A. Bekkers<sup>2</sup>, H.C. Hoogsteden<sup>1</sup>, M.E. Hellemons<sup>1</sup>. <sup>1</sup>Dept. of Pulmonary Medicine, Erasmus MC, Rotterdam. <sup>2</sup>Dept. of Cardiothoracic Surgery, Erasmus MC, Rotterdam, The Netherlands.

11.40 Prevalence and impact of chronic postsurgical pain following laparoscopic donor nephrectomy: a cross-sectional cohort study

M.H.D. Bruintjes<sup>1</sup>, E.V. van Helden<sup>1</sup>, M. de Vries<sup>1</sup>, L.B. Hilbrands<sup>2</sup>, F.C.H. d' Ancona<sup>3</sup>, M.A.H. Steegers<sup>4</sup>, M.C. Warlé<sup>1</sup>. <sup>1</sup>Dept. of Surgery, Radboud University Medical Center, Nijmegen. <sup>2</sup>Dept. of Nephrology, Radboud University Medical Center, Nijmegen. <sup>3</sup>Dept. of Urology, Radboud University Medical Center, Nijmegen. <sup>4</sup>Dept. of Anaesthesiology, Radboud University Medical Center, Nijmegen, The Netherlands

11.50 Investigation of donor-derived cell-free DNA kinetics in stable renal transplant recipients

E.M. Gielis<sup>1</sup>, K. Ledeganck<sup>1</sup>, A. Dendooven<sup>2</sup>, P. Meysman<sup>3</sup>, K. Laukens<sup>3</sup>, J. De Schrijver<sup>4</sup>, S. Van Laecke<sup>5</sup>, M.P. Emonds<sup>6</sup>, M. Vinckx<sup>1</sup>, P. Aerts<sup>1</sup>, B. De Winter<sup>1</sup>, J.L. Bosmans<sup>7</sup>, J. Del Favero<sup>4</sup>, D. Abramowicz<sup>7</sup>. <sup>1</sup>Laboratory of Experimental Medicine and Pediatrics, Univ. of Antwerp, Wilrijk. <sup>2</sup>Dept. of Pathology, Univ. hospital of Antwerp, Edegem. <sup>3</sup>Biomedical informatics research center Antwerpen(Biominia), University of Antwerp, Wilrijk. <sup>4</sup>Multiplicom N.V., part of Agilent Technologies, Niel. <sup>5</sup>Renal Division, Univ. Hospital Ghent, Ghent. <sup>6</sup>Histocompatibility and Immunogenetic Laboratory, Belgian Red Cross Flanders, Mechelen. <sup>7</sup>Dept. of Nephrology and Hypertension, Univ. Hospital of Antwerp, Edegem, Belgium.

Friday, march 16<sup>th</sup>, 2018

12.00 Lunch break

---

**Parallel session I I – Transplant Coordination Van Rijck/Ruys Zaal**

---

*Chairs: to be announced*

**Thema: casus session**

10.30 Programme to be announced

12.00 Lunch break

Chairs: to be announced

Language: English, presentation time 7 min., discussion 3 min.

- 10.30 Impact after live donor nephrectomy: a comparative follow-up study  
S. Janki<sup>1</sup>, A. Dehghan<sup>2</sup>, J. van de Wetering<sup>3</sup>, E. Steyerberg<sup>4</sup>, K.W.J. Klop<sup>1</sup>,  
H.J.A.N. Kimenai<sup>1</sup>, D. Rizopoulos<sup>5</sup>, E.J. Hoorn<sup>6</sup>, S. Stracke<sup>7</sup>, W. Weimar<sup>3</sup>,  
H. Völzke<sup>7</sup>, A. Hofman<sup>2</sup>, J.N.M. Ijzermans<sup>1</sup>. <sup>1</sup>Dept. of Surgery, Subdivision  
of HPB and Transplant Surgery, Erasmus MC, Rotterdam, The Netherlands.  
<sup>2</sup>Dept. of Epidemiology, Erasmus MC, Rotterdam, The Netherlands.  
<sup>3</sup>Dept. of Internal Medicine, Erasmus MC, Rotterdam, The Netherlands.  
<sup>4</sup>Dept. of Public Health, Erasmus MC, Rotterdam, The Netherlands. <sup>5</sup>Dept.  
of Biostatistics, Erasmus MC, Rotterdam, The Netherlands. <sup>6</sup>Dept. of  
Nephrology and Transplantation, Erasmus MC, Rotterdam, The Netherlands.  
<sup>7</sup>Ernst Moritz Arndt University Greifswald, Institute for Community  
Medicine, Greifswald, Germany
- 10.40 Chronic Use of Proton-Pump Inhibitors is Associated with Lower  
Magnesium and Iron Status and Excess Mortality in Renal Transplant  
Recipients  
R.M. Douwes<sup>1</sup>, A.W. Gomes Neto<sup>1</sup>, M.F. Eisenga<sup>1</sup>, R.O.B. Gans<sup>1</sup>, E. V.d.  
Berg<sup>1</sup>, G. Navis<sup>1</sup>, H. Blokzijl<sup>2</sup>, S.J.L. Bakker<sup>1</sup>. <sup>1</sup>Dept. of Internal Medicine,  
University Medical Center Groningen, Groningen. <sup>2</sup>Dept. of Gastro-  
enterology and Hepatology, University Medical Center Groningen,  
Groningen, The Netherlands.
- 10.50 Ribavirin efficacy in upper and lower respiratory tract paramyxovirus  
infection in lung transplant recipients.  
A.E. de Zwart<sup>1</sup>, A. Riezebos-Brilman<sup>2</sup>, J.C. Alffenaar<sup>3</sup>, W. van der Bijl<sup>1</sup>, M.E.  
Erasmus<sup>4</sup>, E.A. Verschuuren<sup>1</sup>. <sup>1</sup>Dept. of Pulmonary diseases and  
Tuberculosis, University Medical Center Groningen, Groningen. <sup>2</sup>Dept. of  
Medical Microbiology, University Medical Center Utrecht, Utrecht. <sup>3</sup>Dept.  
of Pharmacy and clinical Pharmacology, University Medical Center  
Groningen, Groningen. <sup>4</sup>Dept. of Cardiothoracic Surgery, University Medical  
Center Groningen, Groningen, The Netherlands.

Friday, march 16<sup>th</sup>, 2018

- 11.00      Effect Of Different Treatment Modalities For End-Stage Renal Disease After Heart Transplantation  
S. Roest<sup>1</sup>, D.A. Hesselink<sup>2</sup>, I. Kardys<sup>1</sup>, K. Caliskan<sup>1</sup>, J.J. Brugts<sup>1</sup>, A.P.W.M. Maat<sup>3</sup>, A.A. Constantinescu<sup>1</sup>, O.C. Manintveld<sup>1</sup>. <sup>1</sup>Dept. of Cardiology, Erasmus MC, University Medical Center, Rotterdam. <sup>2</sup>Dept. of Internal Medicine, Div of Nephrology and Transplantation, Erasmus MC, Rotterdam. <sup>3</sup>Dept. of Cardiothoracic Surgery, Erasmus MC, University Medical Center, Rotterdam, The Netherlands.
- 11.10      No benefit from 3-month valganciclovir prophylaxis vs preemptive treatment in heart transplantation: should we extend the prophylaxis to 200 days or beyond?  
G. Le Fevere de Ten Hove, O. Van Caenegem, T.H. Timmermans, A. Poncelet. Heart Transplant Unit, Cliniques Universitaires Saint-Luc, Brussels, Belgium.
- 11.20      Donor specific anti-HLA antibodies are not associated with non-anastomotic biliary strictures but both are independent risk factors for graft loss after liver transplantation  
A.C. den Dulk<sup>1</sup>, X. Shi<sup>2</sup>, C. Verhoeven<sup>3</sup>, J. Dubbeld<sup>4</sup>, F.H.J. Claas<sup>5</sup>, R. Wolterbeek<sup>6</sup>, S. Brand-Schaaf<sup>5</sup>, H.W. Verspaget<sup>1</sup>, L. van der Laan<sup>3</sup>, H.J. Metselaar<sup>2</sup>, B. van Hoek<sup>1</sup>, J. Kwekkeboom<sup>2</sup>, D.L. Roelen<sup>5</sup>. <sup>1</sup>Dept. of Gastroenterology and Hepatology, Leiden University Medical Center, Leiden. <sup>2</sup>Dept. of Gastroenterology and Hepatology, Erasmus Medical Center, Rotterdam. <sup>3</sup>Dept. of Surgery, Erasmus Medical Center, Rotterdam, Rotterdam. <sup>4</sup>Dept. of Surgery, Leiden University Medical Center, Leiden. <sup>5</sup>Dept. of Immunohematology and Blood Bank, Leiden University Medical Center, Leiden. <sup>6</sup>Dept. of Medical Statistics, Leiden University Medical Center, Leiden, The Netherlands.
- 11.30      Endovascular treatment of iliac artery stenosis proximal to the transplanted kidney  
D. Molenaar<sup>2</sup>, R.C. van Wissen<sup>1</sup>, M.E.J. Reinders<sup>3</sup>, C.S.P. van Rijswijk<sup>4</sup>, A.F.M. Schaapherder<sup>2</sup>, J.F. Hamming<sup>1</sup>, I.P.J. Alwayn<sup>2</sup>, D.K. de Vries<sup>2</sup>. <sup>1</sup>Dept. of Surgery, Leiden University Medical Center, Leiden. <sup>2</sup>Transplant Center, Leiden University Medical Center, Leiden. <sup>3</sup>Dept. of Nephrology, Leiden University Medical Center, Transplant Center, Leiden. <sup>4</sup>Dept. of Radiology, Leiden University Medical Center, Leiden, The Netherlands.

Friday, march 16<sup>th</sup>, 2018

- 11.40 Kidney transplantation from living donor: Does pre-implantation biopsy predicts outcome?  
*H. Nassereddine<sup>1</sup>, S. Aydin<sup>1</sup>, L. Elens<sup>2</sup>, V. Haufroid<sup>3</sup>, M. De Meyer<sup>4</sup>, N. Kanaan<sup>5</sup>, A. Jouret-Mourin<sup>1</sup>, M. Mourad<sup>6</sup>. <sup>1</sup>Dept. of Pathology - Cliniques Universitaires Saint-Luc, Brussels. <sup>2</sup>Louvain Drug Research institute-Université Catholique de Louvain, Brussels. <sup>3</sup>Louvain Center for Toxicology and Applied Pharmacology, Brussels. <sup>4</sup>Dept. of Surgery and Abdominal Transplantation Division, Brussels. <sup>5</sup>Dept. of Nephrology Dept. - Cliniques Universitaires Saint-Luc, Brussels. <sup>6</sup>Dept. of Surgery and Abdominal Transplantation - Cliniques Saint-Luc, Brussels, Belgium.*
- 11.50 Time trends in liver transplantation for primary biliary cholangitis in Europe over the past three decades  
*Q.P. Janssen<sup>1</sup>, M.H. Harms<sup>1</sup>, R. Adam<sup>2</sup>, C. Duvoux<sup>3</sup>, H.R. van Buuren<sup>1</sup>, B.E. Hansen<sup>1</sup>, H.J. Metselaar<sup>1</sup>. <sup>1</sup>Dept. of Gastroenterology and Hepatology, Erasmus Medical Center, Rotterdam, The Netherlands. <sup>2</sup>Hepato-Biliary Center, AP-HP Paul-Brousse Hospital, Paris Sud University, Paris, France. <sup>3</sup>Dept. of Gastroenterology and Hepatology, Marne-la-Vallée University Hospital, Paris, France.*
- 12.00 Lunch break

---

**Plenary session I 6**

**Willem Burger Zaal**

---

*Chairs: to be announced*

*Spreektaal: Nederlands*

**Topic: “Same borders for doctors and patients?”  
(open for patients)**

13.00 to be announced



Friday, march 16<sup>th</sup>, 2018

---

**Parallel session 17 – Young Professionals**

**Van Rijck/Ruys Zaal**

---

*Chairs: Dr. Dorottya de Vries, surgeon, LUMC, Leiden  
Nathalie Duerinckx, PhD student heart transplantation, Leuven*

**Topic: Young Professionals in Transplantation**

*Spreektaal: Nederlands*

14.00 Vertoning documentaire over niertransplantatie  
met interactieve discussie

15.15 Koffiepauze

Chairs: to be announced

Language: English, presentation time 7 min., discussion 3 min.

- 14.00 3D Endoscopic Donor Nephrectomy Versus Robot-Assisted Donor Nephrectomy: a Detailed Comparison of Two Prospective Cohorts  
*E.E.A.P. Mulder, S. Janki, T. Terkivatan, K.W.J. Klop, J.N.M. IJzermans, T.C.K. Tran. Dept. of Surgery, Division of HPB and Transplant Surgery, Erasmus Medical Center, Rotterdam, The Netherlands.*
- 14.10 Impact of extraction time during organ procurement on kidney function after transplantation.  
*E. Rademaker - van Straalen<sup>1</sup>, P.M. Rebers<sup>1</sup>, J.A.M. Hagens<sup>1</sup>, J. van de Wetering<sup>2</sup>, J.N.M. IJzermans<sup>1</sup>, R.C. Minnee<sup>1</sup>. <sup>1</sup>Dept. of Surgery, division of HPB & Transplant Surgery, Erasmus Medical Center, Rotterdam. <sup>2</sup>Dept. of Nephrology, Erasmus Medical Center, Rotterdam, The Netherlands.*
- 14.20 Impact of parathyroidectomy timing on graft function after kidney transplantation.  
*W.Y. van der Plas<sup>1</sup>, P. von Forstner<sup>1</sup>, M. El Moumni<sup>1</sup>, E.Y. Koh<sup>2</sup>, D.D. Dulfer<sup>1</sup>, T.M. van Ginhoven<sup>3</sup>, J.I. Rotmans<sup>4</sup>, N.M. Appelman-Dijkstra<sup>5</sup>, A. Schepers<sup>6</sup>, E.J. Hoorn<sup>7</sup>, J.T.H.M. Plukker<sup>1</sup>, L. Vogt<sup>8</sup>, A.F. Engelsman<sup>2</sup>, E. Nieveen van Dijkum<sup>2</sup>, S. Kruijff<sup>1</sup>, R.A. Pol<sup>1</sup>, M.H. de Borst<sup>9</sup>. <sup>1</sup>Dept. of Surgery, University Medical Center Groningen, Groningen. <sup>2</sup>Dept. of Surgery, Academic Medical Center, Amsterdam. <sup>3</sup>Dept. of Surgery, Erasmus Medical Center, Rotterdam. <sup>4</sup>Dept. of Internal Medicine, Leiden Medical Center, Leiden. <sup>5</sup>Dept. of Endocrinology, Leiden University Medical Center, Leiden. <sup>6</sup>Dept. of Surgery, Leiden Medical Center, Leiden. <sup>7</sup>Dept. of Nephrology, Erasmus Medical Center, Rotterdam. <sup>8</sup>Dept. of Nephrology, Academic Medical Center, Amsterdam. <sup>9</sup>Dept. of Nephrology, University Medical Center Groningen, Groningen, The Netherlands.*

Friday, march 16<sup>th</sup>, 2018

- 14.30      The impact of aorto-iliac calcifications on patient and graft survival in renal transplant recipients using the TASCII classification.  
*A.A. Rijkse<sup>1</sup>, H.J.A.N. Kimenai<sup>1</sup>, M.A. van der Zijden<sup>2</sup>, J.I. Roodnat<sup>2</sup>, S. Ten Raa<sup>3</sup>, D.C. Bijdevaate<sup>4</sup>, J.N.M. IJzermans<sup>1</sup>, R.C. Minnee<sup>1</sup>. <sup>1</sup>Dept. of Transplantation Surgery, Erasmus Medical Center, Rotterdam. <sup>2</sup>Dept. of Internal Medicine, Erasmus Medical Center, Rotterdam. <sup>3</sup>Dept. of Vascular Surgery, Erasmus Medical Center, Rotterdam. <sup>4</sup>Dept. of Radiology, Erasmus Medical Center, Rotterdam, The Netherlands.*
- 14.40      Possible improvement of tissue donor potential by better definition and diagnosis of active systemic infection or sepsis  
*J.W. van der Veer<sup>1</sup>, E.M.W. Jager<sup>1</sup>, B. Knaake<sup>1</sup>, A. Broeks<sup>1</sup>, R. Bannink<sup>1</sup>, R. Brohet<sup>2</sup>, J.J. Haringman<sup>1</sup>. <sup>1</sup>Intensive Care Unit, Isala, Zwolle. <sup>2</sup>Innovation & Science, Isala, Zwolle, The Netherlands.*
- 14.50      Long-term cognitive effects of kidney transplantation  
*A.L. Ziengs<sup>1</sup>, S.J.L. Bakker<sup>2</sup>, A.M. Buunk<sup>1</sup>, M.F. Eisenga<sup>2</sup>, A.W. Gomes-Neto<sup>2</sup>, J.H. Annema - de Jong<sup>2</sup>, J.M. Spikman<sup>1</sup>. <sup>1</sup>Dept. of Neuropsychology, University Medical Center Groningen, Groningen. <sup>2</sup>Dept. of Nephrology, University Medical Center Groningen, Groningen, The Netherlands.*
- 15.00      Severity of postoperative acute kidney injury predicts development of chronic kidney disease after DCD liver transplantation  
*M. Kalisvaart<sup>1</sup>, A. Schlegel<sup>2</sup>, I. Umbro<sup>3</sup>, J.E. De Haan<sup>4</sup>, I. Scalera<sup>2</sup>, W.G. Polak<sup>1</sup>, J.N.M. IJzermans<sup>1</sup>, D.F.M. Mirza<sup>2</sup>, M.T.P.R. Perera<sup>2</sup>, J. Isaac<sup>2</sup>, A.P. Mitterhofer<sup>5</sup>, P. Muiesan<sup>6</sup>, J. De Jonge<sup>1</sup>. <sup>1</sup>Dept. of Surgery, Erasmus MC University Medical Center, Rotterdam, The Netherlands. <sup>2</sup>Liver Unit, Queen Elizabeth Hospital, Birmingham, United Kingdom. <sup>3</sup>Renal Medicine, Sapienza University, Rome, Italy. <sup>4</sup>Intensive Care, Erasmus MC University Medical Center, Rotterdam, The Netherlands. <sup>5</sup>Internal Medicine, Sapienza University, Rome, Italy. <sup>6</sup>Queen Elizabeth Hospital, Birmingham, United Kingdom*
- 15.10      End of session
- 15.15      Coffee break

Friday, march 16<sup>th</sup>, 2018

---

**Parallel session 19 – Nierteam aan huis**

**Van Weelde Zaal**

*Chairs: Dr. Emma K. Massey, universitair docent, Erasmus MC, Rotterdam  
Prof. dr. Willem Weimar, nefrologist, Erasmus MC, Rotterdam*

*Spreektaal: Nederlands*

14.00      Programma volgt

15.15      Coffee break

---

**Award session - plenary**

**Willem Burger Zaal**

*Chairs: Prof. dr. Marlies E.J. Reinders, President NTV, internist-nefrologist, LUMC  
Prof. dr. Oliver Detry, President BTS, Transplant Surgeon, ULG*

*Language: English*

15.45      Jon van Rood Award NTV  
Belgium best PhD

---

**Closing**

**Willem Burger Zaal**

16.30      Closing by Carla Baan  
Chair of the Local Organising Committee

**Information:**

Secretariaat Nederlandse Transplantatie Vereniging

Postbus 6235

2001 HE Haarlem, The Netherlands

Telefoon + 31(023) 551 3016

Fax + 31 (023) 551 3087

e-mail: [congres@transplantatievereniging.nl](mailto:congres@transplantatievereniging.nl)